

# The Pin Oak Charity Horse Show



MARCH 26 - APRIL 13

2025

79TH YEAR

GREAT SOUTHWEST EQUESTRIAN CENTER | KATY, TX



TO BENEFIT



Texas Children's  
Hospital

Week One MARCH 26 - 30

USEF Premier Hunters  
USEF Level 4 Jumpers  
THJA "A", NAL, WIHS  
USHJA Hunter Derby

Week Two APRIL 2 - 6

USEF Premier Hunters  
USEF Level 5 Jumpers  
THJA "A", NAL, WIHS  
USHJA Hunter Derby  
WCHR

Week Three APRIL 9 - 13

USEF Premier Hunters  
USEF Level 6 Jumpers  
THJA "A", NAL, WIHS  
USHJA Hunter Derby  
WCHR



US EQUESTRIAN FEDERATION  
**HERITAGE**  
COMPETITION





WELCOME LETTER	3
OUR CHARITY	4
<b>INFORMATION</b>	
VITAL INFORMATION	7
AREA MAP	9
WEEK I OFFICIALS	13
WEEK II OFFICIALS	15
WEEK III OFFICIALS	17
RULES & REGULATIONS	20
USEF REGULAR MEMBER COMPLIANCE	35
SPECIAL AWARDS	36
PRIZE MONEY	31
EMERGENCY CONTACTS	42
USHJA ZONE 7 SPECIFICATIONS	27
<b>WEEKS I-III</b>	
HUNTER DIVISION	48
EQUITATION	60
JUMPER DIVISION	62
ANNUAL GROOMS PARTY	69
<b>WEEK I</b>	
WEEK I SCHEDULE	73
<b>WEEK II</b>	
WEEK II SCHEDULE	77
<b>WEEK III</b>	
WEEK III SCHEDULE	81
<b>FORMS</b>	
ENTRY FORM	84
THJA MEMBERSHIP FORM	37
RV & STALL FORM	68

**COVER PHOTO:**

2025 Faces of Pin Oak: Jef Lauwers & Avery Griffin

**PLEASE NOTE:** The Pin Oak Charity Horse Show reserves the right to make unscheduled alterations to timings or to postpone or cancel any events shown in this Prize List. While we have taken every step to make information given as accurate as possible, we cannot accept responsibility for any costs or inconvenience caused by such alterations or cancellations.

# *The Pin Oak Charity Horse Show*

## **Pin Oak, 79 years of helping children and families.**

**Welcome to the 79th year of the Pin Oak Charity Horse Show!** We are honored to have you join us as we continue a legacy that began in 1945—one rooted in the vision that no child should ever be turned away from medical care.

From its founding, Pin Oak has been dedicated to supporting Texas Children's Hospital, and thanks to the unwavering commitment of our equestrian community, we have carried this mission forward for 79 years. Today, the Pin Oak Charity Horse Show is not only a beloved tradition but also a nationally recognized USEF Heritage Competition that continues to make a meaningful impact on the lives of sick children and their families.

To date, Pin Oak has raised over **\$7.5 million for Texas Children's Hospital**, a milestone made possible by the dedication of our exhibitors, sponsors, and supporters like you. Your generosity ensures that we can continue this tradition, creating a brighter future for children in need.

As we celebrate the 2025 Pin Oak Charity Horse Show, we are thrilled to showcase our four-week competition. The first week features an enhanced American Saddlebred schedule, with Hackney Ponies and Morgan Horses as main attractions. The following three weeks highlight some of the nation's top hunters and show jumpers, with fences ranging from 0.75m to Grand Prix.

New this year, week two introduces a **\$25,000 Hunter Classic**, contributing to a total hunter prize fund exceeding **\$315,000**. Meanwhile, jumper riders are competing in **five Grand Prix events**, culminating in the **\$100,000 Grand Prix** on the final Saturday evening. Additionally, junior and amateur exhibitors have exciting opportunities throughout the three weeks. We are excited to see these talented riders and horses in action and grateful for your support in making this event so special!

In addition to enjoying the competition, we invite you to further support our mission by participating in the **Pin Oak Silent Auction** and attending the **Live Auction on Saturday, April 12th, during The Grand Prix**. These exciting fundraising opportunities allow you to bid on exclusive experiences and premier prizes while directly contributing to the care of children.

We hope you enjoy this year's extended schedule, student art contest in the Texas Children's Arena Club and our signature hospitality. We hold deep appreciation for each and every one of you who make this event so special.

See you at the in-gate!

Sincerely,

Friends of Pin Oak





## THE PURPOSE BEHIND THE PIN OAK CHARITY HORSE SHOW

**Beyond the crowning of new champions,** the showcasing of top-caliber equestrian sport and the coming together of old friends and competitors lies a greater purpose to the Pin Oak Charity Horse Show. For more than 75 years, the desire to give back has remained the heart and soul of the horse show.

In 1947, the Pin Oak Charity Horse Show made the organization's very first donation to Texas Children's Hospital, aiding in the planning and building of the now renowned institution. In the decades since then, the support of Pin Oak sponsors, donors and exhibitors has made it possible for the show to donate more than \$7 million to Texas Children's Hospital.

The funds raised by the Pin Oak Charity Horse Show have allowed for the fulfillment of many projects, including the Pin Oak Patient Family Playroom in the intensive care unit of Texas Children's Legacy Tower. Following the completion of the playroom project in 2022, Pin Oak began a three-year commitment to supporting the radiology department at the West Campus. Over the past two years, Pin Oak has contributed a record-breaking \$455,000 to this project, and the team looks forward to the opportunity to present Texas Children's Hospital with another check following this year's horse show!



IN 2023, PIN OAK BEGAN A THREE-YEAR COMMITMENT TO SUPPORTING TEXAS CHILDREN'S HOSPITAL RADIOLOGY DEPARTMENT.



ARELY MEETING MADRONE RANCH'S MINI UNICORN, NOEL PIN OAK III, 2019



PHOTO COURTESY OF TEXAS CHILDREN'S HOSPITAL

THANKS TO THE  
GENEROSITY OF  
SPONSORS, PIN OAK  
PRESENTED TEXAS  
CHILDREN'S  
HOSPITAL WITH  
A CHECK FOR  
\$230,000 IN 2024.





# #1

in  
**Texas**



All-star care for  
the Lone Star State



*Thank you to The Pin Oak Charity  
Horse Show for its longstanding  
support of Texas Children's*





# A TRADITION OF EXCELLENCE, A LEGACY OF GIVING

\$7.5 MILLION  
RAISED



*79th Pin Oak Charity Horse Show*

MARCH 19TH - APRIL 13TH, 2025

[WWW.PINOAK.ORG](http://WWW.PINOAK.ORG)



**NEAREST ANIMAL HOSPITAL**

Texas A&M University      86.5 miles (1hr 25 min)  
Large Animal Hospital  
500 Raymond Stotzer Pkwy  
College Station, TX 77843  
**979-845-3511**

**NEAREST EMERGENCY HOSPITAL**

Memorial Hermann      6 miles (15 min)  
Katy Hospital  
23900 Katy Freeway  
Katy, TX 77494  
**281-644-7000**

Houston Methodist      6.5 miles (15 min)  
West Hospital  
18500 Katy Freeway  
Houston, TX 77094  
**832-552-1000**

Texas Children's Hospital      6.5 miles (15 min)  
West Campus  
18200 Katy Freeway  
Houston, TX 77094  
**832-227-1000**

**ON-SITE VETERINARIAN**

Brazos Valley Equine Hospitals  
6999 Hwy 6  
Navasota, TX 77868  
**(936) 825-2197**

**MAILING ADDRESS**

Great Southwest Equestrian Center  
ATTN: Your Name/ Show Office  
2501 South Mason Road, Suite 100  
Katy, TX 77450

281-578-7669  
[www.gswec.com](http://www.gswec.com)

**DIRECTIONS TO:                    GREAT SOUTHWEST EQUESTRIAN CENTER**

2501 South Mason Road, Suite 100  
Katy, TX 77450

**FROM HOUSTON:**

Take I-10 West and exit Mason Road, Exit 745. Go left (South) for three miles and the Center is on the left.

**FROM SAN ANTONIO:**

Take I-10 East and exit Mason Road, Exit 745. Go right (South) for three miles and the Center is on the left.

**FROM DALLAS:**

Take I-45 South and exit Beltway 8 (Sam Houston Toll Road) South to I-10. Take I-10 West to Mason Road, exit Mason Road, Exit 745. Go left (South) for three miles and the Center is on the left.



# A ROYAL TREAT



Open Daily: 6am -1pm

[www.riveroaksdonuts.com](http://www.riveroaksdonuts.com)

3602 Westheimer Road, Houston, TX

713-961-9458





#### DIRECTIONS:

From Houston: Take I-10 West and exit Mason Road, Exit 745. Go left (South) for three miles and the Center is on the left.

From San Antonio: Take I-10 East and exit Mason Road, Exit 745. Go right (South) for three miles and the Center is on the left.

From Dallas: Take I-45 South and exit Beltway 8 (Sam Houston Toll Road) south to I-10. Take I-10 West to Mason Road, Exit 745. Go left (South) on Mason for three miles and the Center is located on the left.

From the Rosenberg-Richmond area and points south: Take the Grand Parkway (Hwy 99) north. Exit Cinco Ranch Boulevard to Mason Road and go a left (North). The Center is located approximately 100 yards on the right.

The equestrian center is located behind Grace Fellowship Church. At the stop sign in front of the church, make a left onto "Champions Way" and follow the curved road around to the equestrian center entrance.

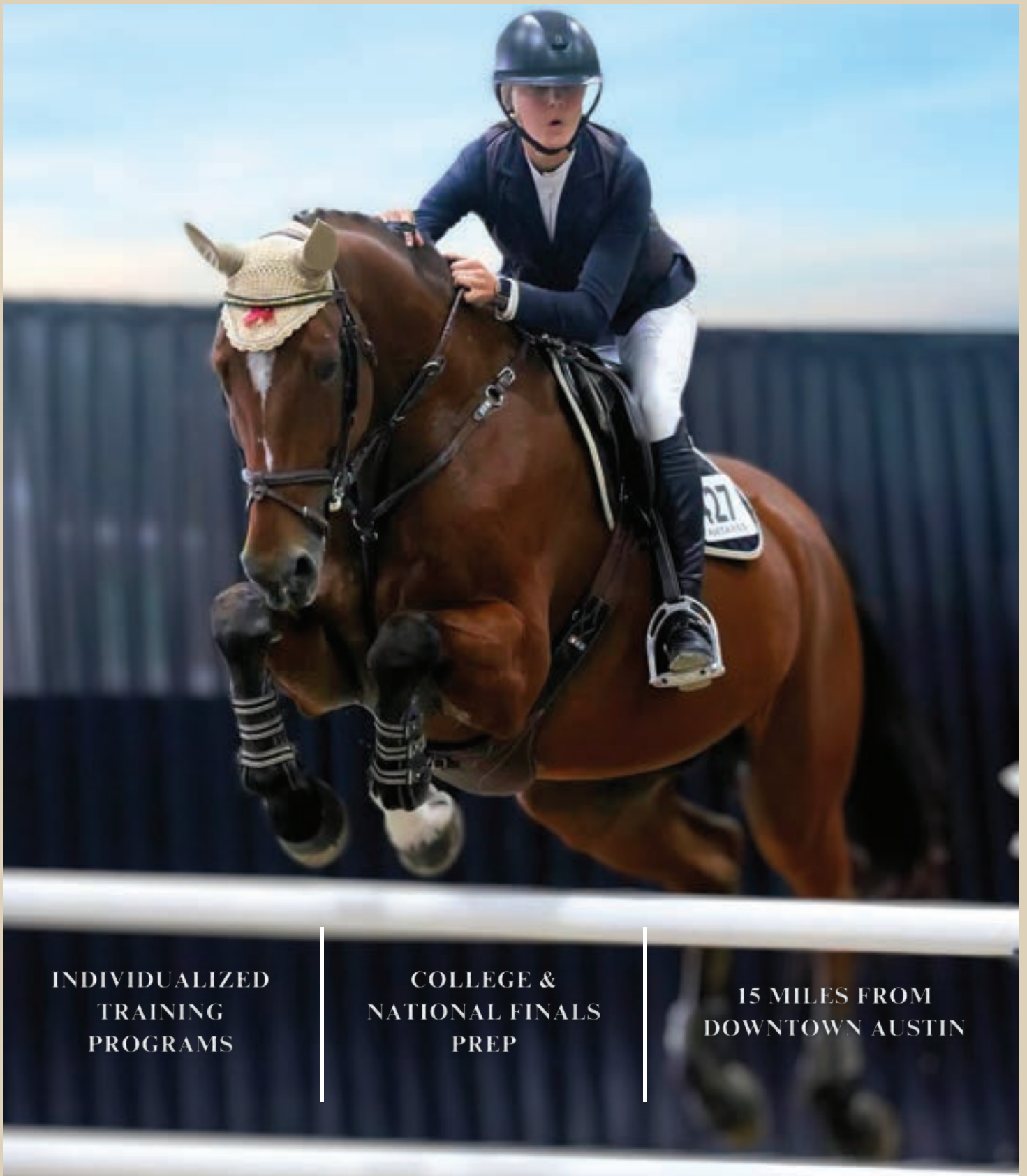

INDIVIDUALIZED  
TRAINING  
PROGRAMS

COLLEGE &  
NATIONAL FINALS  
PREP

15 MILES FROM  
DOWNTOWN AUSTIN



[monarchstablesaustin.com](http://monarchstablesaustin.com)  
[training@monarchstablesaustin.com](mailto:training@monarchstablesaustin.com)  
512-651-0484



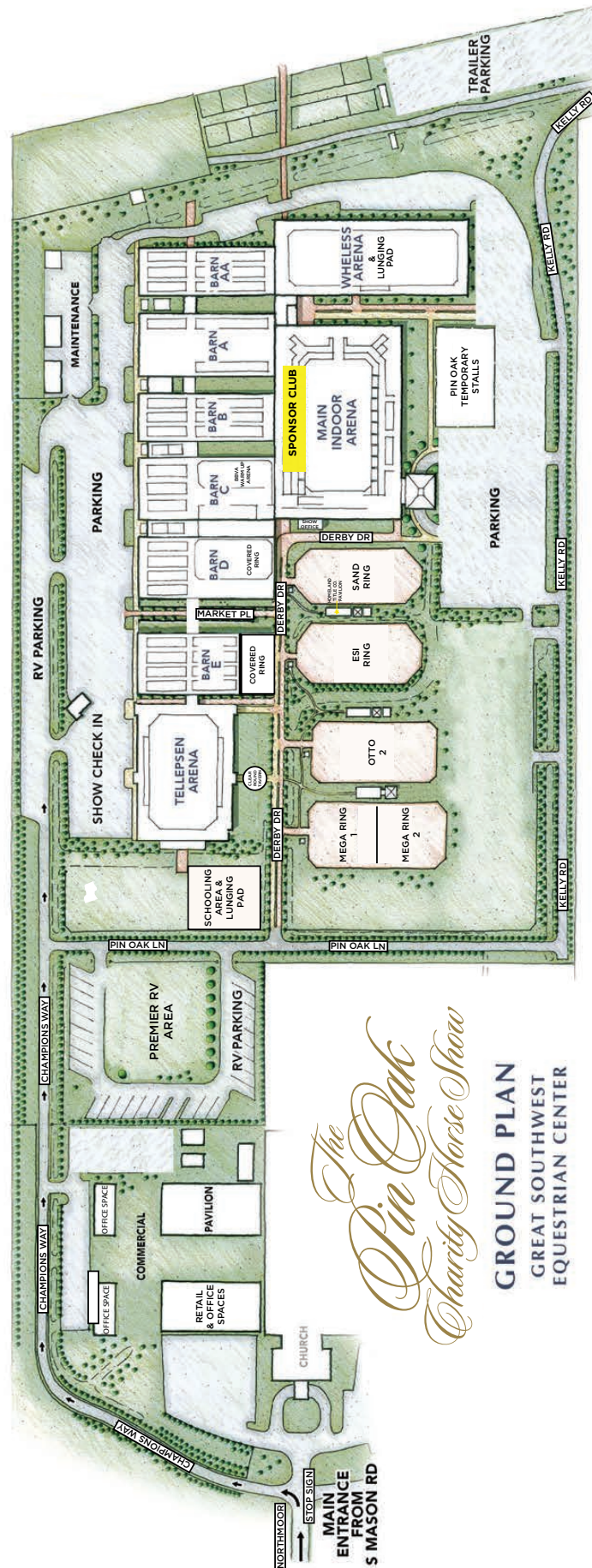

*The Pin Oak Charity Horse Show*

**GROUND PLAN**  
GREAT SOUTHWEST  
EQUESTRIAN CENTER





# WCHR

WORLD CHAMPIONSHIP HUNTER RIDER

## Welcome to the 2025 World Championship Hunter Rider Series!

*Be part of the fun in 2025!*

Scan the code to see the full calendar of  
2025 WCHR Events.



SHAWN MC MILLLEN PHOTOGRAPHY, HIGH DESERT SPORTFOTO, JULIE MERCER/USHJA

**Peter Wetherill Palm Beach Spectacular**  
**February 11-16, 2025**



**Capital Challenge**  
**September 29- October 5, 2025**



**West Coast Spectacular**  
**March 12-16, 2025**



**Central Spectacular**  
**TBD**



# The Pin Oak Charity Horse Show



**Week One: March 26 - 30, 2025**  
Great Southwest Equestrian Center - Katy, TX

**USEF Premier "AA" Hunters  
Level 5 Jumpers**

<b>General Manager</b>	G.S.E.C. Management 281-578-7669	<b>Officials</b>	Management reserves the right to add or vary this list. Hunter, Equitation, Derby, Hunter Breeding Judges
<b>Show Manager</b>	Oliver Kennedy (Brookeville, MD) 443-878-8143 oliverkennedy@capitalchallenge.org		Mary Eufemia (Palm Harbor, FL) Troy Hendricks (Glenmoore, PA) Mike Rosser (Southern Pines, NC) Richard Slocum (Manchester, VT) Andrea Wells (Ocala, FL)
<b>Assistant Show Manager</b>	Pat Duncan (Wellington, FL)		Jumper Judges
<b>Stabling Manager</b>	TBA		Sarah Booker (Columbia, MO) Leslie Brown (Siesta Key, FL) Carl Hansen (Simonton, TX) Michael Howell (Ocala, FL) Annette Longenecker (Annville, PA) Mike Lowry (Tryon, NC)
<b>Security</b>	Deputy John Borowski 832-660-4435		Stewards
<b>Medic</b>	H & H Health and Safety (Houston, TX) 713-204-0690		Bev Bedard (Camp Hill, PA) Hillary Gibbons Neff (Easton, MD) Faith McKay-Alicea (Barto, PA) Candy Fraley (Aubrey, TX) Claire Suevel (Grand Junction, CO) Chris Jones (Calgary, AB) H/J2 Alan Lohman (Poolesville, MD) H Oscar Soberon (West Palm Beach, FL) Main
<b>Veterinarian</b>	Brazos Valley Equine Hospitals 979-324-6301		Schooling Supervisors
<b>Check-In</b>	Rich Ferguson (Hansen, MA) Andy Biles (Katy, TX)		Course Designers
<b>Night Watch &amp; Check In</b>	Ralph Davis (Kaufman, TX) 214-356-4507		Awards & Presentations
<b>Show Secretary</b>	Jennifer Gamboa (Wellington, FL)		Bradley Bowns (Los Angeles, CA) Keedie Leonard (Spottswood, VA) Debbie Stone (Guthrie, OK) Marie Thyssen (Magnolia, TX) Debbie Coleman (Wellington, FL) Glenda Gard (Katy, TX)
<b>Announcers</b>	Sarah Booker (Columbia, MO) Gerald Briggs (Smyrna, TN) Adam Comarty (Warrington, GBR) Sergio DelGuidice (Hackettstown, NJ) Will Mitchell (Katy, TX) Bridget Nolan Howell (Ocala, FL) Dan Persons (Tyler, TX)		Hospitality
<b>Videographers</b>	JK Video www.jkvideo.co		Main Arena Video Wall
<b>Photographers</b>	Andrew Ryback Photography www.andrewryback.com 224-318-5445 or cell 407-616-5812		Music
<b>Farrier</b>	Chris Guillory (Brookshire, TX) 713-498-2428		
<b>Public Relations</b>	Emily Randolph		
<b>Hunter Prize Money</b>		<b>Entry Closing Dates</b>	
2024 Offered - \$102,350		Hunter/Jumper March 11, 2025	
2024 Guaranteed - \$75,000		<b>Recognized by</b>	
2024 Paid - \$77,210		United States Equestrian Federation	
2025 Offered - \$102,350		National Horse Show Association	
2025 Guaranteed - \$75,000		North American League	
		Washington International Horse Show	
		United States Hunter Jumper Association	
		Texas Hunter Jumper Association	

*Augusta Pines*  
FARM



# HUNTERS | JUMPERS | EQUITATION

TRAINERS : ALEXANDRA ANSTETH & EVAN PENDER

FULL BOARD & TRAINING  
SUMMER CAMP  
PREMIER LESSON PROGRAM



AUGUSTAPINESFARM.COM  
281.516.2732  
7925 W. RAYFORD RD., SPRING, TX





# The Pin Oak Charity Horse Show



**Week Two: April 2-6, 2025**

Great Southwest Equestrian Center - Katy, TX

**USEF Premier "AA" Hunters  
Level 5 Jumpers**

**General Manager** G.S.E.C. Management  
281-578-7669

**Show Manager** Oliver Kennedy (Brookeville, MD)  
443-878-8143  
oliverkennedy@capitalchallenge.org

**Assistant Show Manager** Pat Duncan (Wellington, FL)

**Stabling Manager** TBA

**Security** Deputy John Borowski  
832-660-4435

**Medic** H & H Health and Safety (Houston, TX)  
713-204-0690

**Veterinarian** Brazos Valley Equine Hospitals  
979-324-6301

**Check-In** Rich Ferguson (Hansen, MA)  
Andy Biles (Katy, TX)

**Night Watch & Check In** Ralph Davis (Kaufman, TX)  
214-356-4507

**Show Secretary** Jennifer Gamboa (Wellington, FL)

**Announcers** Sarah Booker (Columbia, MO)  
Gerald Briggs (Smyrna, TN)  
Adam Comarty (Warrington, GBR)  
Sergio DelGuidice (Hackettstown, NJ)  
Will Mitchell (Katy, TX)  
Bridget Nolan Howell (Ocala, FL)  
Dan Persons (Tyler, TX)

**Videographers** JK Video  
www.jkvideo.co

**Photographers** Andrew Ryback Photography  
www.andrewryback.com  
224-318-5445 or cell 407-616-5812

**Farrier** Chris Guillory (Brookshire, TX)  
713-498-2428

**Public Relations** Emily Randolph

**Hunter Prize Money**  
2024 Offered - \$97,350  
2024 Guaranteed - \$75,000  
2024 Paid - \$94,267  
2025 Offered - \$97,350  
2025 Guaranteed - \$75,000

## Officials

Management reserves the right to add or vary this list.  
Hunter, Equitation, Derby, Hunter Breeding Judges

David Beisel (Goshen, OH)  
Robert Crandall (Wellington, FL)  
Wendy Peralta (Geneva, FL)  
Tammy Provost (Westfield, IN)  
Bobbi Reber (Aiken, SC)  
Sarah Booker (Columbia, MO)  
Leslie Brown (Siesta Key, FL)  
Carl Hansen (Simonton, TX)  
Michael Howell (Ocala, FL)  
Annette Longenecker (Annville, PA)  
Mike Lowry (Tryon, NC)

## Jumper Judges

Bev Bedard (Camp Hill, PA)  
Hillary Gibbons Neff (Easton, MD)  
Sheila Murphy (Quincy, MA)

## Schooling Supervisors

Candy Fraley (Aubrey, TX)  
Claire Suevel (Grand Junction, CO)

## Course Designers

Manuel Esparza (Monterrey, MEX) Main  
Kevin Holowack (Langley, BC) H  
Kristi Howard (Katy, TX)

## Awards & Presentations

Oscar Soberon (West Palm Beach, FL) J2  
Bradley Bowns (Los Angeles, CA)  
Keedie Leonard (Spottswood, VA)  
Debbie Stone (Guthrie, OK)  
Marie Thyssen (Magnolia, TX)

## Hospitality

Debbie Coleman (Wellington, FL)  
Glenda Gard (Katy, TX)

## Main Arena Video Wall

## Music

Sergio DelGuidice (Hackettstown, NJ)  
Hunter Miracle (Lexington, KY)

The Pin Oak Charity Horse Show is designated as a Heritage Competition by the United States Equestrian Federation.

## Entry Closing Dates

Hunter/Jumper March 11, 2025

## Recognized by

United States Equestrian Federation  
National Horse Show Association  
North American League  
Washington International Horse Show  
United States Hunter Jumper Association  
Texas Hunter Jumper Association



VOLTAIRE  
DESIGN



 @VoltaireDesignUSA\_CAN

 @VoltaireDesign



# The Pin Oak Charity Horse Show



## USEF Premier "AA" Hunters Level 6 Jumpers

**Week Three: April 9-13, 2025**

Great Southwest Equestrian Center - Katy, TX

**General Manager** G.S.E.C. Management  
281-578-7669

**Show Manager** Oliver Kennedy (Brookeville, MD)  
443-878-8143  
oliverkennedy@capitalchallenge.org

**Assistant Show Manager** Pat Duncan (Wellington, FL)

**Stabling Manager** TBA

**Security** Deputy John Borowski  
832-660-4435

**Medic** H & H Health and Safety (Houston, TX)  
713-204-0690

**Veterinarian** Brazos Valley Equine Hospitals  
979-324-6301

**Check-In** Rich Ferguson (Hansen, MA)  
Andy Biles (Katy, TX)

**Night Watch & Check In** Ralph Davis (Kaufman, TX)  
214-356-4507

**Show Secretary** Jennifer Gamboa (Wellington, FL)

**Announcers** Sarah Booker (Columbia, MO)  
Gerald Briggs (Smyrna, TN)  
Adam Comarty (Warrington, GBR)  
Sergio DelGuidice (Hackettstown, NJ)  
Will Mitchell (Katy, TX)  
Bridget Nolan Howell (Ocala, FL)  
Dan Persons (Tyler, TX)

**Videographers** JK Video  
www.jkvideo.co

**Photographers** Andrew Ryback Photography  
www.andrewryback.com  
224-318-5445 or cell 407-616-5812

**Farrier** Chris Guillory (Brookshire, TX)  
713-498-2428

**Public Relations** Emily Randolph

### Officials

Management reserves the right to add or vary this list.  
Hunter, Equitation, Derby, Hunter Breeding Judges

Alice Coke (Sewanee, TN)  
Ginny Edwards (Wellington, FL)  
Marylisa Leffler (Brookeville, MD)  
Tony Sgarlata (Raleigh, NC)  
Sissy Wickes (Wellington, FL)  
Ashley Worthington (Brookeville, MD)

**Jumper Judges** Sarah Booker (Columbia, MO)

Leslie Brown (Siesta Key, FL)  
Carl Hansen (Simonton, TX)  
Michael Howell (Ocala, FL)  
Annette Longenecker (Annville, PA)

**Stewards** Bev Bedard (Camp Hill, PA)  
Hillary Gibbons Neff (Easton, MD)  
Faith McKay-Alicea (Barto, PA)

**Schooling Supervisors** Candy Fraley (Aubrey, TX)  
Claire Suevel (Grand Junction, CO)

**Course Designers** Bernardo Costa Cabral (Lisbon, POR) Main  
Manuel Esparza (Monterrey, MEX) J2  
Kevin Holowack (Langley, BC) H  
Kristi Howard (Katy, TX)

**Awards & Presentations** Meghan Rawlins (Victoria, BC) H  
Bradley Bowns (Los Angeles, CA)  
Debbie Stone (Guthrie, OK)  
Marie Thyssen (Magnolia, TX)

**Hospitality** Debbie Coleman (Wellington, FL)  
Glenda Gard (Katy, TX)

**Main Arena Video Wall** Sergio DelGuidice (Hackettstown, NJ)  
**Music** Hunter Miracle (Lexington, KY)

The Pin Oak Charity Horse Show is designated as a Heritage Competition by the United States Equestrian Federation.

### Entry Closing Dates

Hunter/Jumper March 11, 2025

### Recognized by

United States Equestrian Federation  
National Horse Show Association  
North American League  
Washington International Horse Show  
United States Hunter Jumper Association  
Texas Hunter Jumper Association

**Hunter Prize Money**  
2024 Offered - \$109,350  
2024 Guaranteed - \$75,000  
2024 Paid - \$107,933  
2025 Offered - \$109,350  
2025 Guaranteed - \$75,000



# Shine



*Breed your own...or buy one of ours!*



Shine a Light



[www.oldeoaksfarm.com](http://www.oldeoaksfarm.com)



Sidecar OOM (granddaughter)



Everlasting Shine OOM



Classical Shine OOM



Spitshine OOM





Supporting children, shaping tomorrow!

WENTZFAMILYFOUNDATION.COM

...part of the solution



SCAN ME!



Wentz Family Foundation

EVERY CLASS OFFERED HEREIN WHICH IS COVERED BY THE RULES AND SPECIFICATIONS OF THE CURRENT USEF RULE BOOK WILL BE CONDUCTED AND JUDGED IN ACCORDANCE THEREWITH.

### **CLOSING DATE FOR ALL SHOWS** **March 11, 2025**

**NO FAXED ENTRIES ACCEPTED!**  
**NO PAPER ENTRIES ACCEPTED - ONLINE ONLY**  
**at [www.horshowsonline.com](http://www.horshowsonline.com)**

***Daily adds/scratches are due in the show office by 4pm the day before the class, unless otherwise noted.***

#### **FEES**

All entry fees are stated under each class description.

Office Fee per horse entered - NON REFUNDABLE.....	\$80
Night Watch (Showing & Non Showing).....	\$25
USEF Federation Fee (D&M \$15, USEF \$8).....	\$23
USHJA Fee.....	\$10
USHJA Show Pass Non-Member Fee .....	\$30
IHP Fee per USEF GR207.....	\$35
Stall Fee .....	\$350
Late Entry Fee (if space permits).....	\$150
Non Showing Fee.....	\$150
Scratch Fee .....	\$75
NSF Fee.....	\$50 or 10% of check/credit card charge
Jumper Nominating Fee .....	\$200
RV Hook-up Premier Area.....	\$350
RV Hook-up .....	\$300
RV Late Registration (if space permits).....	\$50 additional
Ringside Amenities.....	\$50

All entries must be secured with an open check or signed credit card authorization for back numbers to be released from the show office.

**Credit Card Customers** - a convenience fee of three (3) percent of the total invoice will be added to all invoices being paid with a credit card. Any check returned by the bank for any reason, or any credit card that is disputed or declined will be charged a \$75 fee or 10% of the amount of the payment, whichever is greater. All declined payments must be replaced by certified funds.

No exhibitor will be permitted to participate at the show while a prior indebtedness is outstanding.

Exhibitors must check out their account each week. Any exhibitor that fails to check themselves out, will be invoiced an additional \$60 by the show. No exhibitor with an outstanding bill from the previous week will be permitted to pick up numbers.

#### **NON SHOWING FEE**

Any horse on the ground for any showing week must be entered in classes or pay the \$150 non showing fee. An entry blank must be on file for EVERY horse on the grounds and pay the non-refundable office fee.

#### **SHOWN NOT ENTERED**

All class entries must be done in the show office prior to the start of the first round. Any horse participating in a class for which they were not entered, will be subject to double the entry fee for the class.

#### **NIGHT WATCH**

All horses occupying a stall, showing and non showing, will be required to pay a show night watch fee of \$25 per show. This service is NOT optional.

#### **PRIZE MONEY**

Prize money will be credited to show bills and paid within 30 days following the conclusion of the show via check. Prize money and refunds will be made payable to the owner of the horse unless otherwise indicated in writing to the show office. A valid SSN or Tax ID information is required for all payments. A FORM W9 is required to be presented for all exhibitors for any prize money to be credited. \*Please note, tax identification numbers are required to pay out horse show prize money.

Prize money will be forfeited for exhibitors who do not wish to provide this information.

After December 31 any unclaimed prize money (uncashed checks) will be considered a donation to the Texas Children's Hospital.

**FOREIGN EXHIBITORS:** Foreign exhibitors are advised that the US Internal Revenue Service requires sporting events to withhold 30% of the prize money won in the United States. Foreign exhibitors should apply for a US Social Security number and be asked to complete FORM W8-BEN prior to any prize money being paid.

#### **REFUNDS AND SCRATCHES**

***No stall fees will be refunded after the close of entries.***

Entry fees, less a \$75 scratch fee will be refunded once a certificate of illness or injury to horse or rider is presented to the show office before the start of each show. It is the responsibility of each exhibitor to officially scratch entries in any classes they do not plan to participate in writing in the show office. Once the show has started, horses which are not shown in classes that they have entered forfeit their entry fees, except if a horse is injured or becomes ill prior to the start of the class(es) entered. This must be accompanied by a certificate from the official show veterinarian.

#### **STALLS**

Stalls for Pin Oak Charity Horse shows will be available for \$350. Stalls are permanent or temporary under tent on dirt, 12' x 12' and 10' x 10' with doors. All horses must show out of a stall. Exception, breeding/in hand horses may purchase a single night stall for \$100. Horses are not permitted to share stalls, unless all horses are owned by members of the same family. Management may limit tack stalls if necessary. Exhibitors are responsible for any damage made to a stall. Charges for damage to any stall will be billed to the exhibitor by GSEC. Damage to any stall panel will incur a \$100 fee per panel. Pin Oak Charity Horse Show is not responsible for any additional housing or security needs for stallions or any other special needs horses. The owners are responsible for any additional modifications and to supply the materials and labor needed to secure their stalls for their horses safety and the horses around them.

Stall requests must be accompanied by stall fees or an open check/credit card authorization. form. Stalls are assigned on a first come basis.

#### **JUMP ORDERS**

A random jump order will be used for all classes in the Main Arena. All classes offering \$5,000 or more will have a drawn order.



### BEDDING/FEED

Shavings will be available for purchase on grounds from 8am - 5pm daily. It is facility policy that no outside shavings or bedding is permitted. A fine of \$100 per stall will be assessed to those violating this policy.

All feed and bedding ordered will be billed through the horse show office. Trainers wishing to do "splits" must provide that information to the show office by the posted weekly deadline. Any splits submitted after the weekly deadline, may be done with an additional split fee. No splits will be done on check out day, no exceptions!

### DRUGS AND MEDICATIONS

Current USEF rules and regulations regarding D & M will be enforced. Sharps and medical waste must be disposed of in sharps containers placed around the barns. All competitors are asked to comply with the USEF Testing Veterinarians in a courteous and efficient manner. Please note that sharps containers MUST be used as provided or penalties will occur. (GR1210.4)

**All showing horses will be invoiced the USEF D & M and USEF Fee of \$23. USHJA fee of \$10 will be assessed to every showing entry.**

### COURSES

Courses will be posted a minimum of 30 minutes prior to the start of each class. At management's discretion, a dotted line may be put into effect to restrict the size of the courtesy circle in hunter classes.

### ATTIRE

Jumper Proper Attire (Jackets) is required for all classes in the Main Arena unless otherwise noted. Jumper Formal Attire is required for all Jumper Class offering \$10,000 or more.

### FOOTING AND ARENA DIMENSIONS

Footing is a priority; rings may be closed to schooling during inclement weather and/or for maintenance at any time during the show at management's discretion.

Mega Ring I - 145' x 265' ESI Footing

Mega Ring II - 145' x 265' ESI Footing

ESI Ring - 140' x 275' ESI Footing

Sand Ring - 140' x 275' DJL Footing

Tellepsen Ring - 150' x 250' Sandy Loam Footing

Main Indoor Arena - 150' x 290' ESI Footing

Wheless Arena - 125' x 250' Sandy Loam Footing

D Barn - 90' x 178' Sandy Loam Footing

South Ring - 150' x 250' DJL All Weather Footing

All dimensions are approximate.

### FIRE/ELECTRICAL REGULATIONS

Barn areas must be kept free of motor vehicles. Roping off or blocking of aisles in barn areas is prohibited. Designated fire lanes must be kept clear. Vehicles parked in unauthorized areas will be towed and subject to recovery of the towing fee from the owner. All extension cords must be Underwriters Laboratory approved for outdoor use. Heavy extension cords are recommended. These rules are for the protection of the exhibitor, his livestock, fellow exhibitors and the public. The use of electric, open flame or space heaters is prohibited. Cooking or any heat/flame food preparation is not allowed in the barn area.

### RV HOOKUPS

Camper spaces are available for \$300 per week in the old section; \$350 per week in the Premier section. One pump out per week is included. Camper pump outs will be done on Saturday of each week. **Anyone needing additional pump outs WILL incur additional charges.** To reserve your RV space a form of payment must be provided in advance. Please fill out a stall, shavings and RV Reservation Form or contact the Pin Oak Charity Horse Show office (281-578-7669). A late fee of \$50 will be assessed for any reservation that is submitted after 3/8/2025. Priority will be given to sponsors/exhibitors staying all three weeks. Sponsors receive priority if received by 3/1/2025. RV spaces sell out every year. Online reservations WILL NOT be accepted after 3/8/2025.

### HEALTH REGULATIONS

**All horse health paperwork must be precopied and left at the front gate upon arrival. Please continually check [www.gswec.com](http://www.gswec.com) and [www.pinoak.org](http://www.pinoak.org) for any additional equine health requirements.**

### HEALTH CERTIFICATES

A health certificate within 21 days of arrival is required upon arrival at the check in point. This may change at the discretion of management.

### COGGINS REGULATIONS

Texas law requires that each horse has a negative EIA certificate dates within in one year. A negative EIA (Coggins Test) must accompany each horse when it enters the grounds. Horses will not be permitted on the grounds without documentation.

### VACCINATIONS

All horses on the grounds must comply with and provide proof of vaccinations per USEF GR845. Horses will not be permitted on the grounds without documentation.

### RESPONSIBILITY

Submission of entry to this show constitutes an agreement to the following: Exhibitor agrees to indemnify and hold harmless Great Southwest Equestrian Center LP, The Pin Oak Charity Horse Show, Oliver Kennedy or their officers, respective directors, agents, show management, employees or representatives against any claims, demands, costs and expenses, including reasonable attorney fees for the defense thereof, arising from the conduct or management of Exhibitor's business or its conditions of this agreement, or contractors, agents, premises. In case of any action or proceeding brought against Great Southwest Equestrian Center LP, The Pin Oak Charity Horse Show, Oliver Kennedy or their officers, respective directors, agents, show management, employees or representatives by reason of any such claim. Exhibitor, upon notice, covenants to defend such action or proceeding by counsel acceptable to Great Southwest Equestrian Center LP or The Pin Oak Charity Horse Show. Exhibitor is responsible for his/her own property, and the Great Southwest Equestrian Center LP is not responsible for accidents, fire or theft.

UNDER TEXAS LAW (CHAPTER 87, CIVIL PRACTICE AND REMEDIES CODE), A FARM ANIMAL PROFESSIONAL OR FARM OWNER OR LESSEE IS NOT LIABLE FOR AN INJURY TO OR THE DEATH OF A PARTICIPANT IN FARM ANIMAL ACTIVITIES, INCLUDING AN EMPLOYEE OR INDEPENDENT CONTRACTOR, RESULTING FROM THE INHERENT RISKS OF FARM ANIMAL ACTIVITIES.



### PETS

All pets on the Show Grounds must be on leashes at ALL times and must not be tied in the aisles in the barns. This will be enforced. Your cooperation will be appreciated for the benefit of exhibitors and spectators. Pursuant to USEF GR301. A \$100 Loose Pet Fee (donated to a local charity) will be collected for all animals found without a leash.

### THJA

No points will be counted toward THJA annual awards until membership dues have been paid and horses have been recorded with THJA. Join THJA Online at [www.thja.org](http://www.thja.org).

### THJA MEMBERSHIP STATEMENT

THJA members shall be eligible to participate in all classes at competitions recognized by THJA. A person/horse may register with the THJA at a recognized horse show as long as the application(s) and payment accompanies the official horse show results. Registrations may also be completed online with a credit card at the THJA web site before the end of the show. **All riders and trainers, in addition to owners of THJA registered horses must be members of THJA for the points to count.**

**PIN OAK CHARITY HORSE SHOW (ONE) (TWO) AND (THREE)** are operated in accordance with current rules of the Texas Hunter & Jumper Association by which it is recognized and rated : "A" in Performance Hunter 3'3" & 3'6", Green 3', 3'3", 3'6" & 3'9" Hunter, Amateur Owner, Green Pony, Pony, Children's Pony, Junior, Short, Medium & Long Stirrup Hunter Children's and Adult Amateur Hunter, Modified Children's and Modified Adult Hunters and Jr/AO Jumper, Children's Jumper, Adult Amateur Jumper. Points for placings in Hunter Breeding, Junior, Pony, Children or Adult Equitation classes, Opportunity Cross Rails & Opportunity Walk/Trot Hunters will be credited in accordance with the rules of the THJA.

### CREDENTIALS

**No number will be release until proper credentials and all signatures are in order.** All exhibitors must provide proof of current memberships. Anyone not presenting current membership credentials (USHJA) will be charged a show pass fee of \$30 per person. All Owners, riders, trainers must provide proof of current USEF Membership to pick up their number. All horses must be recorded with USEF and USHJA. Annual or Life recordings may be required for specific classes. Measurement cards required for all pony hunter, green pony hunter, children's pony hunter and small junior hunter classes. Only one USEF show pass fee per year will be granted by USEF and must be paid on their website.

All entry blanks must be signed in provided spaces by Owner, Trainer, Rider, Driver, Coach or Handler. Anyone under the USEF Show age of 18 must have the signature of a parent or guardian on the entry blank. It is the responsibility of the person making the entry to execute properly and complete all necessary information pertaining to each entry made in accordance with the rules of USEF. Every Owner, Rider, Trainer, Coach must sign a waiver online.

### AMATEUR CERTIFICATION

Every person who has reached his 18th birthday (as of Dec 1 of the previous year) and competes in classes restricted to amateurs under USEF rules must possess current USEF amateur certification. Riders must be a member of USEF to apply for amateur certification. USEF GR1307

### RIBBONS/TROPHIES/CHAMPIONSHIPS

All hunter classes will receive a trophy and eight ribbons unless otherwise noted. All equitation classes will received a trophy and eight ribbons unless otherwise noted. All jumper classes will receive a trophy and eight ribbons unless otherwise noted. Each hunter and jumper section will receive a champion and reserve award based on points unless otherwise noted. Hunter Championship will be rendered per USEF Rules. Jumper Championships will be rendered using the Bonus Point system. Bonus points will be applied to one class per section (see section for specific class). Ties in Jumper Championships will be broken by the highest place horse in the bonus class.

### SCHOOLING

There will be limited schooling at times to be posted in Show Office. Ticketed paid schooling, if time permits, may be available.

### QUESTIONS, DISPUTES & PROTESTS

All protests and questions not covered by these rules shall be decided and interpreted by the Competition Committee, whose decision shall be final. Disputes should be presented to the Show Manager prior to filing a formal protest under the provisions of USEF Chapter VI. A protest must be in writing and may be made to the Competition Committee by and exhibitor, agent, trainer or parent of a Jr. Exhibitor for any violation of USEF Rules.

### MOTORIZED VEHICLES

Minors who do not have a valid driver's license which allows them to operate a motorized vehicle in the state in which they reside will not be permitted to operate a motorized vehicle of any kind, including, but not limited to, golf carts, motorcycles, scooters, or farm utility vehicles, on the competition grounds of licensed competitions. Minors who have a valid temporary license may operate the above described motorized vehicles as long as they are accompanied by an adult with a valid driver's license. The parent/legal guardian or individual who signs the entry blank as a parent or guardian of a minor operating a motorized vehicle in violation of this rule are solely responsible for any damages, claims, losses or actions resulting from that operation. Violations of this rule will be cause for penalties against those responsible for the child committing the offense. Wheelchairs and other mobility assistance devices for individuals with disabilities are exempt from this rule. The unsafe use of personal electronic transport devices, as determined by the competition officials and management in their sole discretion, that do not require a driver's license to operate, including but not limited to segways, hover boards, and single wheeled scooters is prohibited on competition grounds. Operating such devices in areas where people gather may be deemed "unsafe use" if there is a risk of harm to others. If the operator of the device is a minor, the parent/legal guardian or individual who signs the entry blank as a parent or guardian of a minor operating the device in violation of this rule is accountable and may be subject to penalties. Wheelchairs and other mobility assistance devices for individuals with disabilities are exempt from this rule.

### USEF MEMBERSHIP STATEMENT

Life, senior active and junior active members shall be eligible to participate in all classes at Regular Competitions, Eventing Competitions at the Modified Level or above and Combined Driving Competitions at the Advanced Level, Dressage, Reining and Vaulting Competitions and Endurance Rides. A non-member may participate as a handler, rider, driver, owner, lessee, or agent at Regular Competitions, Eventing Competitions, Dressage Competitions, Reining Competitions and Combined Driving Competitions upon payment of a Show Pass fee. Participants in the following classes are exempted from the Requirements of this rule: 1) leadline; 2) exhibitions; 3) games and races; 4) classes for 4-H members; 5) walk trot and academy classes (academy classes are classes limited to horses used regularly in a lesson program); 6) USDF introductory level tests, pas de deux and quadrille classes; 7) assistant handlers in Dressage Sport Horse Breeding classes

### Federation Entry Agreement:

By entering a Federation-licensed Competition and signing this entry blank as the Owner, Lessee, Trainer, Manager, Agent, Coach, Driver, Rider, Handler, Vaultor or Longeur and on behalf of myself and my principals, representatives, employees and agents, I agree that I am subject to the Bylaws and Rules of the United States Equestrian Federation, Inc. (the "Federation") and the local rules of Pin Oak Horse Show (Competition). I agree to be bound by the Bylaws and Rules of the Federation and of the competition. I will accept as final the decision of the Hearing Committee on any question arising under the Rules, and agree to release and hold harmless the competition, the Federation, their officials, directors and employees for any action taken under the Rules. I represent that I am eligible to enter and/or participate under the Rules, and every horse I am entering is eligible as entered. I also agree that as a condition of and in consideration of acceptance of entry, the Federation and/or the Competition may use or assign photographs, videos, audios, cable - casts, broadcasts, internet, film, new media

or other likenesses of me and my horse taken during the course of the competition for the promotion, coverage or benefit of the competition, sport, or the Federation. Those likenesses shall not be used to advertise a product and they may not be used in such a way as to jeopardize amateur status. I hereby expressly and irrevocably waive and release any rights in connection with such use, including any claim to compensation, invasion of privacy, right of publicity, or to misappropriation. The construction and application of Federation rules are governed by the laws of the State of New York, and any action instituted against the Federation must be filed in New York State. See GR908.1.

If not currently a USEF Active Competing member or Subscriber, I acknowledge that I will be enrolled for no cost as a USEF Fan and my USEF Fan Account will continue to annually automatically renew in USEF's sole discretion. Additionally, I acknowledge that the benefits of a USEF Fan are subject to change without notice. USEF may in its sole discretion, at any time, terminate my USEF Fan status.

### SAFE SPORT

All USEF Life and Senior Active members, as well as participants who have regular contact with minor athletes, are required to comply with the U.S. Center for SafeSport training requirement to be eligible to participate in the competition. All participants must adhere to the U.S. Center for SafeSport Code, USEF Safe Sport Policy, and the Minor Athlete Abuse Prevention Policies. More information about these can be found at [www.usef.org](http://www.usef.org).







Rendezvous Farm

Nada Wise  
Tomball, TX



Hunters | Jumpers | Equitation

Training and Sales  
nadawise@hotmail.com  
www.rendezvousfarm.net





**Southern Way Farm would like to thank our clients  
for their Generous support of the Pin Oak Charity  
Horse Show and Texas Children's Hospital**



MTM Campedu owned by Emersales LLC -winner of the 2023 \$25,000 Pinoak Hunter Classic

---

**Nora Nichols**

---

**The Tuttle Family • The Corwin Family • The Wald Family • Torchy's Tacos**

**The Emerson Family • The Huff Family • The Findeisen Family**

**The Brown Family • The Calaway / Ledoux Family**

---



*wafarm*

W A F A R M

SHOWS &  
TRAINING

IMPORT &  
SALES



HUNTERS

JUMPERS

EQUITATION



WALID ALRASHID

[www.wafarm.org](http://www.wafarm.org)

832-938-6662

21403 Mueschke Road, Tomball TX



**2025 ZONE 7 HUNTER, JUMPER AND EQUITATION SPECIFICATIONS (AR, KS, LA, MO, OK, TX) In accordance with GR1111.4:**  
**All Members may compete for Zone Awards or money in any stage contiguous to Zone 7: MS, TN, KY, IA, IL, NE, CO & NM.**

## AGE GROUP EQUITATION: ADULT SECTION

### Sections offered and requirements:

- Adult Equitation 18-35
- Adult Equitation 36-49
- Adult Equitation 50 & Over

### Cross Entry:

No cross entry restrictions

### Fence Height:

- 3'0" with spreads not to exceed the fence height.
- Combinations will be permitted.

### Combining/Dividing Sections:

The Equitation sections may be combined if there are fewer than six (6) entries in a section.

### Awards:

Zone Horse of the Year Awards will be presented annually to the following sections:

- Adult Equitation (combined)

## CHILDREN'S HUNTER HORSE

### Sections offered and requirements:

- Children's Hunter Horse 14 & Under
- Children's Hunter Horse 15-17

### Cross Entry:

### Rider:

The rider may compete on a different horse or pony at the same show in any other division or section for which the rider/ horse/pony are eligible.

### Horse/Pony:

The horse or pony may be shown by a different rider in any other division or section at the same show except Junior Hunter or a different age group in Children's Hunter Exception: A state association may adopt more (but not less) restrictive cross entry rules.

### Horse and Rider Combination:

The same horse (pony)-and-rider combination may not compete at the same competition in any class in which fence heights exceed 3'3" or any Junior Hunter Section.

### Fence Height:

- 3'0" with spreads not to exceed fence height
- In and outs will be permitted
- Distances will not be adjusted for ponies.

### Combining/Dividing Sections:

If there are fewer than six (6) in the Children's Hunter Horse section or fewer than four (4) entries in the Children's Hunter Pony, the sections may, but are not required to be combined. One award will be offered for the combined section.

The Children's Hunter Horse section may but are not required to be combined with the Adult Amateur section if there are fewer than six (6) in either section or with the Children's Hunter Pony if there are fewer than four (4), but may not be combined with both sections.

### Awards:

Zone Horse of the Year Awards will be presented annually to the following sections:

- Children's Hunter Horse 14 & Under
- Children's Hunter Horse 15-17

## LOW CHILDREN'S HUNTER HORSE

### Eligibility:

- Open to exhibitors who have not reached their 18<sup>th</sup> birthday as of December 1 of the current competition year.

### Cross Entry:

### Riders:

Riders may not cross enter into any class or section at the same competition where fences exceed 1.05m or 3'3".

### Horse/Pony:

N/A

### Horse and Rider Combination:

Horse/Pony and Rider combinations may not cross enter into any class or section at the same competition where fences exceed 2'9".

### Fence Height:

- 2'6"

### Combining/Dividing Sections:

The Low Children's Hunter and Low Adult Amateur Hunter and sections may be combined if there are fewer than three (3) entries in either section.

### Awards:

Zone Horse of the Year Awards will be presented annually to the following section: Low Children's Hunter Horse

## CHILDREN'S HUNTER PONY

### Sections Offered and requirements:

- Small/Medium Children's Pony
- Large Children's Pony
- Prize Money: No minimum prize money is required.

### Cross Entry:

### Rider:

The rider may compete on a different horse or pony at the same competition in any other division or section where the jumps do not exceed 3'0".

### Horse/Pony:

Ponies competing in Children's Hunter Pony may not cross enter into the regular pony section.

### Horse and Rider Combination:

N/A

### Fence Height:

- Small ponies: 2'0" with spreads not to exceed fence height
- Medium Ponies: 2'0"-2'3" with spreads not to exceed fence height
- Large Ponies: 2'6" with spreads not to exceed fence height
- Combinations will not be permitted.

### Combining/Dividing Sections:

The Children's Hunter Pony and the Children's Hunter Horse sections may, but are not required to be combined if there are fewer than four (4) entries in the Children's Hunter Pony and fewer than six (6) in the Children's Hunter Horse section.

Children's Hunter Pony may not be combined with Adult Amateur Hunter.

### Awards:

Zone Horse of the Year Awards will be presented annually to the following sections:

- Children's Hunter Pony- Small/Medium
- Children's Hunter Pony- Lar



**2025 ZONE 7 HUNTER, JUMPER AND EQUITATION SPECIFICATIONS (AR, KS, LA, MO, OK, TX) In accordance with GR1111.4:**  
**All Members may compete for Zone Awards or money in any stage contiguous to Zone 7: MS, TN, KY, IA, IL, NE, CO & NM.**

**LOW CHILDREN'S HUNTER PONY**

**Eligibility:**

Open to exhibitors who have not yet reached their 18<sup>th</sup> birthday as of December 1<sup>st</sup> of the current competition year.

**Cross Entry:**

**Rider:**

Low Pony Hunter riders may not cross enter into any class where fences exceed 2'9" or into the Children's Hunter Pony, Pony Hunter, or Green Pony Hunter Section at the same competition.

**Fence Height:**

- 2'0"

**Combining/Dividing Sections:**

- Can be split.
- If there are fewer than three (3) ponies the Low Pony Hunter section may combine with the Low Children's Hunter Pony section.
- If there are still fewer than three (3) entries after the Low Pony Hunter section has been combined with the Low Children's Hunter Pony section, these sections may only then combine with the Low Children's Hunter Horse.

**Awards:**

Zone Horse of the Year Awards will be presented annually to the following sections:

- Low Children's Hunter Pony

**AGE GROUP EQUITATION: CHILDREN'S/ JUNIOR SECTION**

To be judged on performance and soundness, suitability to count.

**Sections offered and requirements:**

- Junior Equitation 14 & Under
- Junior Equitation 15 - 17

**Cross Entry:**

**Riders:**

N/A

**Horse/Pony:**

N/A

**Horse and Rider Combination:**

A horse/ rider combination may not cross enter between height sections.

**Fence Height:**

- Junior Equitation 14 & Under: 3'0" with spreads not to exceed fence height
- Junior Equitation 15- 17: 3'6" with spreads not to exceed fence height
- Combinations will be permitted

**Combining/Dividing Sections:**

- The Equitation sections maybe combined if there are fewer than six(6) entries in a section.

**Awards:**

Zone Horse of the Year Awards will be presented annually to the following sections:

- Equitation 14 & Under
- Equitation 15 - 17

**JUNIOR JUMPER**

Classes to be scored under Table 1; Table II, Section 1, Sections 2(a), 2(b), 2(c), or 2(d), or 3; or Table IV (Optimum Time)

**Sections Offered and requirements:**

- 1.00/1.05m Junior Jumper
- 1.10/1.15m Junior Jumper

**Cross Entry:**

Competition Management may restrict cross entries between 1.10/1.15m and 1.00/1.05m sections at the same competition if stated in the prize list.

**Rider:**

N/A

**Horse/Pony:**

N/A

**Horse and Rider Combination:**

Cross entry into any class at 1.20m and above is not permitted for the same horse/rider combination at the same competition. 1.00/1.05m Junior Jumper horse/rider combinations may cross enter into the 1.10/1.15m Junior Jumpers at the same competition. 1.10/1.15m Junior Jumper horse/rider combinations may cross enter into the 1.00/1.05m Junior Jumpers at the same competition. Horse/rider combinations may enter only one classic, if both 1.00/1.05m and 1.10/1.15m are offered.

**Fence Height:**

- Junior Jumper 1.00m to 1.05m
- Junior Jumper 1.10m to 1.15m

**Combining/Dividing Sections:**

A combined Amateur/Junior's Jumper section may be offered, and if entries warrant, may thereafter be split into separate sections. If only one section of the Junior's/Amateur Jumper is offered or if the 1.00/1.05m and 1.10/1.15m section are combined, the classes will be conducted at the height appropriate for each section.

**Awards:**

Zone Horse of the Year Awards will be presented annually to the following section:

- 1.00/1.05m Junior Jumper section
- 1.10/1.15m Junior Jumper section





**2025 ZONE 7 HUNTER, JUMPER AND EQUITATION SPECIFICATIONS (AR, KS, LA, MO, OK, TX) In accordance with GR1111.4:**  
**All Members may compete for Zone Awards or money in any stage contiguous to Zone 7: MS, TN, KY, IA, IL, NE, CO & NM.**

**JUDGING FOR ALL HUNTER SECTIONS:**

- To be judged on performance and soundness, suitability to count.
- Horses and Ponies are not required to jog for soundness in the Adult Amateur Hunter, Children's Hunter Horse, and Children's Hunter Pony sections.

**ELIGIBILITY FOR ADULT AMATEURS: HUNTER, JUMPER AND EQUITATION:**

- To be ridden by exhibitors who have reached their 18<sup>th</sup> birthday as of December 1 of the current competition year and who hold a current USEF Amateur certification. Open to horses and ponies. State rules **MAY** prohibit entry of ponies.

**ELIGIBILITY FOR CHILDREN'S: HUNTER, JUMPER AND EQUITATION:**

- To be ridden by exhibitors who have **not** reached their 18<sup>th</sup> birthday as of December 1 of the current competition State rules **MAY** prohibit entry of ponies.

**ADULT AMATEUR HUNTER**

**Sections offered and requirements:**

- Adult Amateurs – may be split into three (3) sections

**Cross Entry:**

**Riders:**

The rider may compete on a different horse or pony at the same competition in any other division or sections for which the rider/horse or pony are eligible.

**Horse/Pony:**

The horse or pony may be shown by a different rider in any other division or section at the same competition except Amateur Owner Hunter or a different age group in Adult Amateur Hunter Exception: A state association may adopt more (but not less) restrictive cross entry rules.

**Horse and Rider Combination:**

The same horse (pony)-and-rider combination may not compete at the same competition in Amateur Owner 3'3" or any class in which fence heights exceed 3'3" Exception: Equitation and USHJA National Hunter Derby.

**Fence Height:**

- 3'0" with spreads not to exceed the fence height.
- Courses will not be adjusted for ponies.
- In and outs will be permitted

**Combining/Dividing Sections:**

**MAY** be split into three sections:

- Adult Amateurs 18 – 35
- Adult Amateurs 36 – 49
- Adult Amateurs 50 & over

If any of the Adult Amateur sections have fewer than six (6) entries, they may, but are not required to combine with other section(s).

If there are fewer than six (6) entries in the entire section, the Adult Amateur entries may, but are not required to combine with Children's Hunter Horse, but not the Children's Hunter Pony. One award will be offered for the combined sections.

**Awards:**

Zone Horse of the Year Awards will be presented annually to the following sections:

- Adult Amateur Hunter 18- 35
- Adult Amateur 36- 49
- Adult Amateur 50 & over

**LOW ADULT AMATEUR HUNTER**

**Eligibility:**

- Open to exhibitors who have reached their 18<sup>th</sup> birthday as of December 1 of the current competition year.

**Cross Entry:**

**Riders:**

Riders may not cross enter into any class or section at the same competition where fences exceed 1.05m or 3'3".

**Horses:**

N/A

**Horse and Rider Combination:**

Horse and Rider combinations may not cross enter into any class or section at the same competition where fences exceed 2'9"

**Fence Height:**

- 2'6"

**Combining/Dividing Sections:**

The Low Adult Amateur Hunter and Low Children's Hunter sections may be combined if there are fewer than three (3) **entries in either section.**

**Awards:**

Zone Horse of the Year Awards will be presented annually to the following section: Low Adult Amateur Hunter

**AMATEUR JUMPER**

Classes to be scored under Table 1; Table II, Section 1, Sections 2(a), 2(b), 2(c), or 2(d), or 3; or Table IV (Optimum Time)

**Sections Offered and requirements:**

- 1.00/1.05m Amateur Jumper
- 1.10/1.15m Amateur Jumper

**Cross Entry:**

Competition Management may restrict cross entries between 1.10/1.15m and 1.00/1.05m sections at the same competition if stated in the prize list.

**Riders:**

If a 1.10/1.15m Amateur Jumper classic is offered in the Junior's or Amateur Jumpers and the rider has jumped above 1.30m at that show then they are not eligible for any Classic in the Junior's/Amateur Jumper sections.

**Horse/Pony:**

N/A

**Horse and Rider Combination:**

Cross entry into any class at 1.20m and above is not permitted for the same horse/rider combination at the same competition. 1.00/1.05m Amateur Jumper horse/rider combinations may cross enter into the 1.10/1.15m Amateur Jumpers at the same competition. 1.10/1.15m Amateur Jumper horse/rider combinations may cross enter into the 1.00/1.05m Amateur Jumpers at the same competition. Horse/rider combinations may enter only one classic, if both 1.00/1.05m and 1.10/1.15m are offered.

**Fence Height:**

- Amateur Jumper 1.00m to 1.05m
- Amateur Jumper 1.10m to 1.15m

**Combining/Dividing Sections:**

A combined Amateur/ Junior Jumper section may be offered, and if entries warrant, may thereafter be split into separate sections.

If only one section of the Junior's/Amateur Jumper is offered or if the 1.00/1.05m and 1.10/1.15m sections are combined, the classes will be conducted at the height appropriate for each section.

**Awards:**

Zone Horse of the Year Awards will be presented annually to the following sections: • 1.00/1.05m Amateur Jumper • 1.10/1.15m Amateur Jumper





R-CRANCH.COM

# SADDLE UP FOR WAGYU



# 15% OFF

Entire Order  
**Code: PINOAK15**  
Redeem by 5/1/25

**FAMILY-OWNED ★ PREMIUM WAGYU BEEF ★ TEXAS RAISED**

Prize money awarded in classes will be distributed in the following manner, unless otherwise noted in the class listing.

### Hunter Prize Money Distribution

Amount	1st	2nd	3rd	4th	5th	6th	7th	8th
\$100	30	22	15	13	10	10	R	R
\$150	45	33	23	19	15	15	R	R
\$175	53	39	27	22	17	17	R	R
\$200	60	44	30	26	20	20	R	R
\$225	68	50	34	29	22	22	R	R
\$275	83	61	42	35	27	27	R	R
\$300	90	65	45	39	30	30	R	R
\$325	98	72	49	42	32	32	R	R
\$425	128	94	64	55	42	42	R	R
\$500	150	110	75	65	50	50	R	R
\$625	188	138	94	81	62	62	R	R
\$810	244	179	122	105	80	80	R	R
\$1000	300	220	150	130	100	100	R	R
\$1500	450	330	225	150	105	90	75	75

### Jumper Prize Money Distribution

Amount	1st	2nd	3rd	4th	5th	6th	7th	8th	9th	10th	11th	12th
\$100	30	22	15	13	10	10	R	R	-	-	-	-
\$250	75	55	38	32	25	25	R	R	-	-	-	-
\$500	150	100	65	65	60	60	R	R	-	-	-	-
\$750	225	165	113	97	75	75	R	R	-	-	-	-
\$1000	300	220	150	130	100	100	R	R	-	-	-	-
\$1500	450	330	225	195	165	135	R	R	-	-	-	-
\$2000	600	440	300	260	200	200	R	R	-	-	-	-
\$5000	1500	900	600	500	450	400	350	300	R	R	-	-
\$10,000	3000	2000	1000	700	600	500	450	400	400	350	300	300
\$15,000	4500	3300	1850	1100	800	650	550	500	450	450	425	425
\$20,000	6000	4400	2600	1600	1200	1000	700	550	500	500	475	475
\$25,000	7500	5500	3250	2000	1500	1250	1000	750	750	500	500	500
\$30,000	9000	6600	3900	2400	1800	1500	1200	900	900	600	600	600
\$50,000	15000	11000	6500	4000	3000	2500	2000	1500	1500	1000	1000	1000
\$100,000	30000	22000	13000	8000	6000	5000	4000	3000	3000	2000	2000	2000





# FRIO

RIVER

VODKA



handcrafted from a  
blend of grain & wheat



cold filtered



sustainable

Partnered  
with



**AMERICAN  
RIVERS**

Life Depends on Rivers™



FIND FRIO  
VODKA



**TEXAS SUPER STAKE SERIES****\$2,500 TEXAS GREEN HUNTER 3'/3'3" SUPER STAKE**

**Class** **Entry Fee \$275**  
3' and 3'3" Green Hunter Horses must be enrolled in the **Texas Green Hunter 3'/3'3" Super Stake Series** in order to be eligible. To be judged on performance, soundness, suitability and manners. To be scored under the open numeric system. Each competitor will jump one round of approximately 10 jumps. Participants must enter in the show office by entry closing time the day prior to the Super Stake Class.

**\$2,500 & ADD BACK (\$75 PER HORSE) TO BE PAID TO THE 1<sup>ST</sup> – 8<sup>TH</sup> PLACES**  
(1) 30% (2) 22% (3) 15% (4) 10% (5) 7% (6) 6% (7) 5% (8) 5%

**\$1,000 TEXAS PERFORMANCE HUNTER 3'3"/3'6" SUPER STAKE**

**Class** **Entry Fee \$125**  
3'3"/3'6" Performance Hunter Horses must be enrolled in the **Texas Performance Hunter 3'3"/3'6" Super Stake Series** in order to be eligible. To be judged on performance, soundness, suitability and manners. To be scored under the open numeric system. Each competitor will jump one round of approximately 10 jumps. Participants must enter in the show office by entry closing time the day prior to the Super Stake Class.

**\$1,000 & ADD BACK (\$30 PER HORSE) TO BE PAID TO THE 1<sup>ST</sup> – 8<sup>TH</sup> PLACES**  
(1) 30% (2) 22% (3) 15% (4) 10% (5) 7% (6) 6% (7) 5% (8) 5%



Information & Enrollment  
available at....  
[superseriesgroup.com](http://superseriesgroup.com)



# Brookside Pine Farms

HUNTERS • JUMPERS • EQUITATION • SALES



**BERRY PORTER**

(936) 672-1260

berry@brooksidepinefarms.com

CONROE, TEXAS | (281) 224-2746



[www.BrooksidePineFarms.com](http://www.BrooksidePineFarms.com)



**Pin Oak Charity Horse Show I, II, III**

USEF # PIN OAK HORSE SHOW I (317743) | PIN OAK CHARITY (31) | PIN OAK CHARITY HORSE SHOW III (317746)

WEEK 1: USEF Premier Hunters  
USEF Level 5 Jumpers

WEEK 2: USEF Premier Hunters  
USEF Level 5 Jumpers

WEEK 3: USEF Premier Hunters  
USEF Level 6 Jumpers



# MAAPP

## MINOR ATHLETE ABUSE PREVENTION

REQUIRED OF ALL PARTICIPANTS

### LEARN ABOUT MAAP POLICIES



Safe Sport Training



Travel



One-On-One Interactions



Social Media & Electronic Communications



Read about these & more at [usef.org/MAAPP](https://usef.org/MAAPP)

### REPORT MAAPP POLICY VIOLATIONS



[usef.org/safe-sport/reporting](https://usef.org/safe-sport/reporting)

859-225-6915 or Text Anonymously 2USEF (28733)



U.S. CENTER FOR  
SAFESPORT™



# *The Pin Oak Charity Horse Show*

## **PIN OAK GRAND CHAMPION AWARDS**

Horses (riders for the equitation) must have shown in their respective section two of the weeks of the Pin Oak Charity Horse Show to be eligible for an award.

<b>ADULT AMATEUR HUNTER</b>	<b>PONY HUNTER</b>	<b>JUNIOR HUNTER 3'6"</b>
<b>AMATEUR OWNER HUNTER 3'3"</b>	<b>GREEN PONY HUNTER</b>	<b>JUNIOR HUNTER 3'3"</b>
<b>AMATEUR OWNER HUNTER 3'6"</b>	<b>LOW ADULT HUNTER</b>	<b>3'3"/3'6" EQUITATION</b>
<b>CHILDREN'S HUNTER</b>	<b>LOW CHILDREN'S HUNTER</b>	

## **\$10,000 PIN OAK CHARITY HORSE SHOW JUMPER RIDER BONUS**

**Awarded based on classes held during all Three Weeks of Shows.**

The Pin Oak Jumper Rider Bonus is offered in the Open Jumper Sections.

Open points awarded to the riders best placed horse in each class, regardless of horse.

To be eligible, the rider must have competed in all three weeks in at least one eligible class as listed below.

Points will be tracked using the 15, 9, 6, 4, 3, 2, 1, 1/2 format.

Bonus Prize Money will be credited during week three.

<b>DIVISION</b>	<b>CLASSES</b>	<b>PRIZE MONEY</b>
<b>Open Jumper</b> \$10,000 Bonus money awarded	All Open classes held at 1.20, 1.25, 1.30, 1.35, 1.40 and welcome each week.	Leading Rider - \$5,000 2nd Place - \$3,000 3rd Place - \$2,000

### **DIRECTIONS:**

From Houston: Take I-10 West and exit Mason Road, Exit 745. Go left (South) for three miles and the Center is on the left.

From San Antonio: Take I-10 East and exit Mason Road, Exit 745. Go right (South) for three miles and the Center is on the left.

From Dallas: Take I-45 South and exit Beltway 8 (Sam Houston Toll Road) south to I-10. Take I-10 West to Mason Road, Exit 745. Go left (South) on Mason for three miles and the Center is located on the left.

From the Rosenberg-Richmond area and points south: Take the Grand Parkway (Hwy 99) north. Exit Cinco Ranch Boulevard to Mason Road and go a left (North). The Center is located approximately 100 yards on the right.

The equestrian center is located behind Grace Fellowship Church. At the stop sign in front of the church, make a left onto "Champions Way" and follow the curved road around to the equestrian center entrance.

*The  
Pin Oak  
Charity Horse Show*

**Follow  
Us on  
Social  
Media**



STAY CONNECTED FOR ALL OF THE LATEST UPDATES  
ON THE 2025 PIN OAK CHARITY HORSE SHOW



on LinkedIn at  
Pin Oak Charity Horse Show



on Facebook as  
The Pin Oak Charity Horse Show



on TikTok @PinOakCharityHorseShow



on Instagram @pinoakhouston

● 2501 S. Mason Rd. #100 Katy, TX 77450 ● [info@pinoak.org](mailto:info@pinoak.org) ●





Leaving One Out, LLC  
Wishes the 2025  
Pin Oak Competitors  
The best of luck!





## ***TimeSlice Technologies Corporation***

**HorseShowsOnline.com**



### ***Show Management Software***

#### ***Features***

**Secure Credit Card Processing & Card Vaulting**

**Fully PCI Compliant**

**Online entries - Free for competitors**

**Online Add/Scratch for competitors!**

**USEF electronic results submissions and  
membership verification!**

**Publish your shows FREE to HorseShowsOnline.com!**

#### ***New***

**Interested in your personal show results history?**

**Upgrade your account to a *Silver* membership today!**

**Research and analysis by horse, owner, trainer, rider**

**View historical results and track your performance.**

**View results at  
HorseShowsOnline.com**

***The Professional's Choice***

***sales@timeslice.ca 905-760-9997***





## WAIVER AND RELEASE OF LIABILITY, ASSUMPTION OF RISK AND INDEMNITY AGREEMENT

For and in consideration of United States Equestrian Federation, Inc. dba US Equestrian ("USEF") allowing me, the undersigned, to participate in any capacity (including as a rider, driver, handler, vaulter, longeur, lessee, owner, agent, coach, official, trainer or volunteer) in a USEF sanctioned, licensed or approved event or activity, including but not limited to equestrian clinics, practices, shows, competitions and related or incidental activities and GREAT SOUTHWEST EQUESTRIAN CENTER ("USEF Event" or "USEF Events"); I, for myself, and on behalf of my spouse, children, heirs and next of kin, and any legal and personal representatives, executors, administrators, successors, and assigns, hereby agree to and make the following contractual representations pursuant to this Agreement (the "Agreement"):

A. RULES AND REGULATIONS: I hereby agree that I have read, understand, and agree to be bound by all applicable Federation Bylaws, rules, and policies including the USEF Safe Sport Policy and Minor Athlete Abuse Prevention Policies (MAAPP) as published at [www.usef.org](http://www.usef.org), as amended from time to time.

B. ACKNOWLEDGMENT OF RISK: I knowingly, willingly, and voluntarily acknowledge the inherent risks associated with the sport of equestrian and know that horseback riding and related equestrian activities are inherently dangerous, and that participation in any USEF Event involves risks and dangers including, without limitation, the potential for serious bodily injury (including broken bones, head or neck injuries), sickness and disease (including communicable diseases), trauma, pain & suffering, permanent disability, paralysis and death; loss of or damage to personal property (including my mount & equipment) arising out of the unpredictable behavior of horses; exposure to extreme conditions and circumstances; accidents involving other participants, event staff, volunteers or spectators; contact or collision with other participants and horses, natural or manmade objects; adverse weather conditions; facilities issues and premises conditions; failure of protective equipment (including helmets); inadequate safety measures; participants of varying skill levels; situations beyond the immediate control of the USEF Event organizers and competition management; and other undefined, not readily foreseeable and presently unknown risks and dangers ("Risks").

### WARNING:

**UNDER TEXAS LAW (CHAPTER 87, CIVIL PRACTICE AND REMEDIES CODE), A FARM ANIMAL PROFESSIONAL IS NOT LIABLE FOR AN INJURY TO OR THE DEATH OF A PARTICIPANT IN FARM ANIMAL ACTIVITIES RESULTING FROM THE INHERENT RISKS OF FARM ANIMAL ACTIVITIES.**

C. ASSUMPTION OF RISK: I understand that the aforementioned Risks may be caused in whole or in part or result directly or indirectly from the negligence of my own actions or inactions, the actions or inactions of others participating in the USEF Events, or the negligent acts or omissions of the Released Parties defined below, and I hereby voluntarily and knowingly assume all such Risks and responsibility for any damages, liabilities, losses, or expenses that I incur as a result of my participation in any USEF Events. I also agree to be responsible for any injury or damage caused by me, my horse, my employees or contractors under my direction and control at any USEF Event.

D. WAIVER AND RELEASE OF LIABILITY, HOLD HARMLESS AND INDEMNITY: In conjunction with my participation in any USEF Event, I hereby release, waive and covenant not to sue, and further agree to indemnify, defend and hold harmless the following parties: USEF, USEF Recognized Affiliate Associations, the United States Olympic & Paralympic Committee (USOPC), USEF clubs, members, Event participants (including athletes/riders, coaches, trainers, judges/officials, and other personnel), the Event owner, licensee, and competition managers; the promoters, sponsors, or advertisers of any USEF Event; any charity or other beneficiary which may benefit from the USEF Event; the owners, managers, or lessors of any facilities or premises where a USEF Event may be held; and all directors, officers, employees, agents, contractors, and volunteers of any of the aforementioned parties (**Individually and Collectively, the "Released Parties" or "Event Organizers"**), with respect to any liability, claim(s), demand(s), cause(s) of action, damage(s), loss, or expense (including court costs and reasonable attorney fees) of any kind or nature ("**Liability**") which may arise out of, result from, or relate in any way to my participation in the USEF Events, including claims for Liability caused in whole or in part by the negligent acts or omissions of the Released Parties.

E. COMPLETE AGREEMENT AND SEVERABILITY CLAUSE: This Agreement represents the complete understanding between the parties regarding these issues and no oral representations, statements or inducements have been made apart from this Agreement. If any provision of this Agreement is held to be unlawful, void, or for any reason unenforceable, then that provision shall be deemed severable from this Agreement and shall not affect the validity and enforceability of any remaining provisions.

**I HAVE CAREFULLY READ THIS DOCUMENT IN ITS ENTIRETY, UNDERSTAND ALL OF ITS TERMS AND CONDITIONS, AND KNOW IT CONTAINS AN ASSUMPTION OF RISK, RELEASE AND WAIVER FROM LIABILITY, AS WELL AS A HOLD HARMLESS AND INDEMNIFICATION OBLIGATIONS.**

By signing below, that I have read, understand, and agree to be bound by all applicable Federation Bylaws, rules, and policies including the USEF Safe Sport Policy and Minor Athlete Abuse Prevention Policies (MAAPP) as published at [www.usef.org](http://www.usef.org), as amended from time to time, as well as all terms and provisions of this Prize List. If, despite this Agreement, I, or anyone on my behalf or the minor's behalf, makes a claim for Liability against any of the Released Parties, I will indemnify, defend and hold harmless each of the Released Parties from any such Liabilities as the result of such claim.

**The parties agree that this agreement may be electronically signed. The parties agree that the electronic signatures appearing on this agreement are the same as handwritten signatures for the purposes of validity, enforceability, and admissibility.**

☐ RIDER/DRIVER/HANDLER/VAULTER/LONGEUR ☐ OWNER ☐ TRAINER ☐ OFFICIAL ☐ STAFF ☐ VOLUNTEER ☐ COACH (IF APPLICABLE)

Signature: \_\_\_\_\_ Date: \_\_\_\_\_ Print Name: \_\_\_\_\_

Parent/Guardian Signature: (Required if Rider/Driver/Handler/Vaulter/Longeur is a minor) \_\_\_\_\_ Date: \_\_\_\_\_

Print Parent//Guardian Name: \_\_\_\_\_ Emergency Contact Phone No. \_\_\_\_\_

11.16.23

# Memorial Park Hunters

*Congratulations to our THJA year end Champions and Reserve Champions!*



Elisabeth Marek & Last Man  
Reserve Champion  
15-17 Equitation



Emmy Canterbury & Bada Bing Bada Blue  
Champion Small/Medium  
Children's Pony Hunter



MJ Maestas & Major Sassafras  
Reserve Champion  
Short Stirrup



Laura Carter & Divides Freedom Spirit – Champion Large Children's Pony Hunter

**Our clients are successful in the Hunter, Jumper, Pony and Equitation rings.**

We have a place for the beginner rider, the competitive rider and everyone in between!

Top Ponies and Horses For Sale

Patty Roberts (713) 683-8636 • (713) 805-8266 • Houston, Texas

Conveniently located inside the 610 Loop

[memorialparkhunters.com](http://memorialparkhunters.com)



# MEDICAL EMERGENCIES

## NEAREST ANIMAL HOSPITAL

Texas A&M University                      86.5 miles (1hr 25 min)  
Large Animal Hospital  
500 Raymond Stotzer Pkwy  
College Station, TX 77843  
979-845-3511

## NEAREST EMERGENCY HOSPITAL

Memorial Hermann                      6 miles (15 min)  
Katy Hospital  
23900 Katy Freeway  
Katy, TX 77494  
281-644-7000

Houston Methodist                      **6.5 miles (15 min)**  
West Hospital  
18500 Katy Freeway  
Houston, TX 77094  
832-552-1000

Texas Children's Hospital              6.5 miles (15 min)  
West Campus  
18200 Katy Freeway  
Houston, TX 77094  
832-227-1000

## ON-SITE VETERINARIAN

Brazos Valley Equine Hospitals  
281-255-2280  
979-324-6301



*Find your Equine Partner in Crime*



Contact us today  
[info@epicsporthorses.com](mailto:info@epicsporthorses.com)



Follow us on Instagram  
[@epichorsesales](https://www.instagram.com/epichorsesales)





*Celebrate the Connection*



KRISTIE SCHOLTEN  
photography

832-971-8886





*PROUD SUPPORTERS OF THE PIN OAK CHARITY HORSE SHOW*



**REAL TEXAS  
BAR-B-Q®**

21799 KATY FWY || KATY TX, 77450 || 832-772-7242

**RUDYS.COM**



# PJP FARM

**One of the Premier Hunter  
Jumper training facilities in  
the Country**

We cater to clientele competing in all levels of Hunters and Jumpers,  
from Ponies to Grand Prix Jumpers.

Our customers and their horses have been Champion at all the major  
competitions in the Country.

We offer for Sale some of the finest horses on the circuit today,  
as well as talented imported Horses.



**Peter Pletcher**

714 Superior Rd, Magnolia, Texas, 77354  
713.822.4617



### THJA Membership Application Form – 2025

Membership year runs from December 1 to November 30

Please make sure your horses and owners are also registered in order to receive points

NAME: \_\_\_\_\_

ADDRESS: \_\_\_\_\_

CITY, ST, ZIP \_\_\_\_\_

TELEPHONE: (H) \_\_\_\_\_ (O) \_\_\_\_\_

E-Mail Address: \_\_\_\_\_

USEF # / THJA # \_\_\_\_\_

Check here if you do not want your phone number in the THJA Member Roster.

Check here to keep your name/address off membership roster and mailing lists.

Check here if you do not want your e-mail address in the THJA Member Roster.

Check here if your USEF status is AMATEUR

Check here if your USEF status is JUNIOR

Check here if your USEF status is PROFESSIONAL

Category of Membership Desired: ☐ 1 Year ☐ 2 Years ☐ 3 years  
(Membership cannot change from Junior to Senior during renewal period)

\_\_\_\_\_ JUNIOR (Not having reached 18<sup>th</sup> birthday on 12/1/21): \$40.00/YR  
Junior Rider's Birth date \_\_\_\_\_ (Required)

\_\_\_\_\_ SENIOR (18 & Over): \$50.00/YR  
Amateur Owner Birth date \_\_\_\_\_ (Required)

\_\_\_\_\_ LIFE: \$700.00

If you register at a horse show by the last day of the show, your membership counts toward any points won at that show.

1. Give this completed form to the show secretary along with the proper payment.
2. Go to the THJA web site [www.thja.org](http://www.thja.org) and register online with a credit card.
3. Call Ann Yaffe at the number below and complete your registration by phone. There is a \$20 charge for this service.
4. Mail this completed form along with your check to the address shown below.

Please submit this form with the appropriate dues made payable to "THJA" to:  
Ann Yaffe ■ 3299 Beaver Creek Drive ■ Brookshire, TX 77423 ■ (281) 934-3251

## Hunter Division



\* WEEKS II - III

### GENERAL CONDITIONS AND SPECIFICATIONS

Classes will be judged on performance and soundness unless otherwise noted in the prize list. All USEF hunter divisions and classes will be split and/or combined per current USEF rules. All others will be split using the California split method. Each Section will be awarded Champion and Reserve.

Handy Hunter Classes: In all divisions which include a handy hunter, please see time schedule for the designated handy round. The course may include trot jumps, hand gallop, and/or you may be asked to mount or dismount.

Jogging - Horses/ponies are required to trot a circle on a loose rein at the end of their round in each over fences class in all rated sections.

Horses/ponies may be asked to return to the ring and trot another circle at the judges discretion.

CLASS	CLASS #	SECTION FEE	CLASS FEE	PRIZE MONEY
-------	---------	-------------	-----------	-------------

### \$4,050 HIGH PERFORMANCE HUNTER SECTION

Fences 4' to 4'6".

High Performance Hunter U/S	426	\$425	\$125 per class	\$810
High Performance Hunter	427, 428, 429, 430			\$810

### GREEN HUNTER SECTION

#### \$1,250 3' GREEN HUNTER

3' Green Hunter U/S	451	\$225	Section Only	\$150
3' Green Hunter	452, 453, 454, 455 *			\$275

\* Class will also count as Texas Green Hunter Super Stake and USHJA Incentive Stake - you must enter them to receive a score

#### \$1,250 3'3" GREEN HUNTER

3'3" Green Hunter U/S	456	\$225	Section Only	\$150
3'3" Green Hunter	457, 458, 459, 460 *			\$275

\* Class will also count as Texas Green Hunter Super Stake and USHJA Incentive Stake - you must enter them to receive a score. Horses must be entered in the Green 3' or 3'3" section to be eligible for the Texas Green Hunter Super Stake or the USHJA Incentive Stake.

#### \$3,000 3'6" GREEN HUNTER

3'6" Green Hunter U/S	416	\$325	Section Only	\$500
3'6" Green Hunter	417, 418 *, 419, 420			\$625

\* Class will also count as USHJA Green Incentive Stake - you must enter them to receive a score.

#### \$3,000 3'9" GREEN HUNTER

3'9" Green Hunter U/S	421	\$325	Section Only	\$500
3'9" Green Hunter	422, 423 *, 424, 425			\$625

\* Class will also count as USHJA Green Incentive Stake - you must enter them to receive a score.

### \$4,500 PERFORMANCE HUNTER SECTION

#### \$3,000 3'6" PERFORMANCE HUNTER

3'6" Performance Hunter U/S	431	\$325	\$100 per class	\$500
3'6" Performance Hunter	432, 433*, 434, 435			\$625

\* Class will also count as Texas Hunter Super Stake - you must enter them to receive a score. Horses must be entered in the regular performance class to be eligible for the Texas Hunter Super Stake.

#### \$2,000 3'3" PERFORMANCE HUNTER

3'3" Performance Hunter U/S	436	\$250	\$75 per class	\$300
3'3" Performance Hunter	437, 438*, 439, 440			\$425

\* Class will also count as Texas Hunter Super Stake - you must enter them to receive a score. Horses must be entered in the regular performance class to be eligible for the Texas Hunter Super Stake.





CLASS	CLASS #	SECTION FEE	CLASS FEE	PRIZE MONEY
-------	---------	-------------	-----------	-------------

### \$6,000 CONFORMATION HUNTER SECTION

\$3,000 3'6" GREEN CONFORMATION HUNTER - Conformation to count 30%. Model to count 1/2 points.

*Individual classes may not be entered, except for Model, which must be entered separately.*



\* WEEKS II - III

Green Conformation Hunter Model	400	No entry fee		Ribbons
3'6" Green Conformation Hunter U/S	401	\$325	Section Only	\$500
3'6" Green Conformation Hunter	402, 403 *, 404, 405			\$625

\* Class will also count as USHJA Green Incentive Stake - you must enter them to receive a score.

\$3,000 3'9" HIGH PERFORMANCE CONFORMATION HUNTER - Conformation to count 30%. Model to count 1/2 points.

*Individual classes may not be entered, except for Model, which must be entered separately.*

HP Conformation Hunter Model	410	No entry fee		Ribbons
3'9" HP Conformation Hunter U/S	411	\$325	Section Only	\$500
3'9" HP Conformation Hunter	412, 413, 414, 415			\$625

### \$3,000 AMATEUR OWNER HUNTER 3'3" SECTION

Fences 3'3". USEF amateur card required.

#### \$1,500 AMATEUR-OWNER HUNTER 3'3" – RIDERS 18-35

3'3" AO Hunter 18-35 U/S	471	\$225	Section Only	\$200
3'3" AO Hunter 18-35	472, 473 *, 474, 475			\$325

#### \$1,500 AMATEUR-OWNER HUNTER 3'3" – RIDERS 36 & Over

3'3" AO Hunter 36 & Over U/S	476	\$225	Section Only	\$200
3'3" AO Hunter 36 & Over	477, 478*, 479, 480			\$325

\* Class will count as first round of the Amateur Owner Hunter Classic.

### \$4,000 AMATEUR OWNER HUNTER 3'6" SECTION

Fences 3'6". USEF amateur card required.

#### \$2,000 AMATEUR-OWNER HUNTER 3'6" - RIDERS 18-35

3'6" AO Hunter 18-35 U/S	461	\$250	Section Only	\$300
3'6" AO Hunter 18-35	462, 463*, 464, 465			\$425

#### \$2,000 AMATEUR-OWNER HUNTER 3'6" - RIDERS 36 & Over

3'6" AO Hunter 36 & Over U/S	466	\$250	Section Only	\$300
3'6" AO Hunter 36 & Over	467, 468*, 469, 470			\$425

\* Class will count as first round of the Amateur Owner Hunter Classic.

### \$3,000 JUNIOR HUNTER 3'3" SECTION

Fences 3'3". USEF measurement card required for any horse wanting small junior hunter points. Riders may not cross enter into any class at 3'6" or higher in the hunter division, higher than 3'9" in the equitation division or higher than 1.25m in the jumper divisions at the same competition.

#### \$1,500 JUNIOR HUNTER 3'3" - RIDERS 15 & UNDER

3'3" Junior Hunter 15 & Under U/S	611	\$225	Section Only	\$200
3'3" Junior Hunter 15 & Under	612, 613*, 614, 615			\$325

#### \$1,500 JUNIOR HUNTER 3'3" - RIDERS 16 - 17

3'3" Junior Hunter 16-17 U/S	616	\$225	Section Only	\$200
3'3" Junior Hunter 16-17	617, 618*, 619, 620			\$325

\* Class will count as first round of the Junior Hunter 3'3" Classic.

CLASS	CLASS #	SECTION FEE	CLASS FEE	PRIZE MONEY
-------	---------	-------------	-----------	-------------

### \$8,000 JUNIOR HUNTER 3'6" SECTION

Fences 3'6". USEF measurement card required for any horse showing in small junior hunter classes.



\* WEEKS II - III

#### \$2,000 LARGE JUNIOR HUNTER 3'6" - RIDERS 15 & UNDER

3'6" Large Junior Hunter 15 & Under U/S	491	\$250	Section Only	\$300
3'6" Large Junior Hunter 15 & Under	492, 493*, 494, 495			\$425

#### \$2,000 LARGE JUNIOR HUNTER 3'6" - RIDERS 16 - 17

3'6" Large Junior Hunter 16-17 U/S	496	\$250	Section Only	\$300
3'6" Large Junior Hunter 16-17	497, 498*, 499, 500			\$425

#### \$2,000 SMALL JUNIOR HUNTER 3'6" - RIDERS 15 & UNDER

3'6" Small Junior Hunter 15 & Under U/S	481	\$250	Section Only	\$300
3'6" Small Junior Hunter 15 & Under	482, 483*, 484, 485			\$425

#### \$2,000 SMALL JUNIOR HUNTER 3'6" - RIDERS 16 - 17

3'6" Small Junior Hunter 16-17 U/S	486	\$250	Section Only	\$300
3'6" Small Junior Hunter 16-17	487, 488*, 489, 490			\$425

\* Class will count as first round of the Junior Hunter 3'6" Classic.

### \$3,000 PONY HUNTER SECTION

USEF measurement card required. *Individual classes may not be entered, except for Model, which must be entered separately.*

#### \$1,000 LARGE PONY HUNTER - Fences 3'.

Large Pony Hunter Model	550	\$200	Section Only	Ribbons
Large Pony Hunter U/S	551			\$100
Large Pony Hunter	552 (Conf), 553*, 554, 555			\$225

#### \$1,000 MEDIUM PONY HUNTER - Fences 2'6".

Medium Pony Hunter Model	540	\$200	Section Only	Ribbons
Medium Pony Hunter U/S	541			\$100
Medium Pony Hunter	542 (Conf), 543*, 544, 545			\$225

#### \$1,000 SMALL PONY HUNTER - Fences 2'3".

Small Pony Hunter Model	530	\$200	Section Only	Ribbons
Small Pony Hunter U/S	531			\$100
Small Pony Hunter	532 (Conf), 533*, 534, 535			\$225

\* Class will count as first round of the Pony Hunter Classic





CLASS	CLASS #	SECTION FEE	CLASS FEE	PRIZE MONEY
-------	---------	-------------	-----------	-------------

### \$1,000 GREEN PONY HUNTER SECTION

USEF measurement card required. *Individual classes may not be entered, except for Model, which must be entered separately.*



#### \$500 LARGE GREEN PONY HUNTER - Fences 2'9"

\* WEEKS II - III

Large Green Pony Hunter Model	570		\$25	Ribbons
Large Green Pony Hunter U/S	571	\$160	Section Only	\$100
Large Green Pony Hunter	572 (Conf), 573*, 574, 575			

#### \$500 SMALL/ MEDIUM GREEN PONY HUNTER - Fences 2'3" & 2'6"

Sm/Med Green Pony Hunter Model	560		\$25	Ribbons
Sm/Med Green Pony Hunter U/S	561	\$160	Section Only	\$100
Sm/Med Green Pony Hunter	562 (Conf), 563*, 564, 565			

\* Class will count as first round of the Green Pony Hunter Classic

### \$300 "TAKE 2" THOROUGHBRED HUNTER SECTION

Fences 3'. Open to thoroughbred horses who's registration can be verified by one of the following methods: Jockey club certificate of foal registration, horse's lip tattoo and 5-cross pedigree lookup results from the Jockey Club, Letter from the Jockey Club verifying the horse's identity. A minimum of 3 entries are required to fill.

Take 2 Thoroughbred Hunter U/S	671	\$120	\$45	\$100
Take 2 Thoroughbred Hunter	672, 673		\$45	\$100

### \$1,400 CHILDREN'S HUNTER SECTION

Fences 3'. Run in accordance with USHJA Zone 7 specs.

#### \$700 CHILDREN'S HUNTER HORSE - RIDERS 14 & UNDER

Children's Hunter 14 & Under U/S	516	\$200	\$40	Ribbons
Children's Hunter 14 & Under	517, 518*, 519, 520		\$50	\$175

#### \$700 CHILDREN'S HUNTER HORSE - RIDERS 15 - 17

Children's Hunter 15-17 U/S	521	\$200	\$40	Ribbons
Children's Hunter 15-17	522, 523*, 524, 525		\$50	\$175

\* Class will count as first round of the Children's Hunter Classic

### CHILDREN'S HUNTER PONY SECTION

USEF Measurement card required. Fences 2' (Small ponies); 2'3" (Medium Ponies); 2'6" (Large Ponies) Run in accordance with USHJA Zone 7 specs.

Children's Hunter Pony U/S	621	\$160	\$40	Ribbons
Children's Hunter Pony	622, 623*, 624, 625		\$40	

\* Class will count as first round of the Children's Pony Hunter Classic

### LOW CHILDREN'S HUNTER SECTION

Fences 2'6". Open to Junior Riders. Run in accordance with USHJA Zone 7 specs.

Low Children's Hunter U/S	596	\$160	\$40	Ribbons
Low Children's Hunter	597, 598*, 599, 600		\$40	

\* Class will count as first round of the Low Children's Hunter Classic



**TRAINER: DANIEL BEDOYA**

- Boarding/Training Package
- FEI and National Shows
- Imports and Sales
- Young Horse Development

# BEDOYA TRAINING STABLES



**EXCEPTIONAL CARE**

**INTEGRITY**

**PROVEN RESULTS**



📞 512-658-4630  
 🌐 Linbedoya@gmail.com

🌐 [www.bedoyatrainingstables.com](http://www.bedoyatrainingstables.com)  
 📍 Magnolia TX



CLASS	CLASS #	SECTION FEE	CLASS FEE	PRIZE MONEY
-------	---------	-------------	-----------	-------------

### \$2,100 ADULT AMATEUR HUNTER SECTION

Fences 3'. USEF Amateur Certification Required. Run in accordance with USHJA Zone 7 specs.



\* WEEKS II - III

#### \$700 ADULT AMATEUR HUNTER - RIDERS 18 - 35

Adult Amateur Hunter 18-35 U/S	511	\$200	\$40	Ribbons
Adult Amateur Hunter 18-35	512, 513*, 514, 515		\$50	\$175

#### \$700 ADULT AMATEUR HUNTER - RIDERS 36 - 49

Adult Amateur Hunter 36-49 U/S	506	\$200	\$40	Ribbons
Adult Amateur Hunter 36-49	507, 508*, 509, 510		\$50	\$175

#### \$700 ADULT AMATEUR HUNTER - RIDERS 50 & Over

Adult Amateur Hunter 50 & Over U/S	501	\$200	\$40	Ribbons
Adult Amateur Hunter 50 & Over	502, 503*, 504, 505		\$50	\$175

\* Class will count as first round of the Adult Amateur Hunter Classic

### LOW ADULT AMATEUR HUNTER SECTION

Fences 2'6". USEF Amateur Certification Required. Run in accordance with USHJA Zone 7 specs.

Low Adult Hunter U/S	591	\$160	\$40	Ribbons
Low Adult Hunter	592, 593*, 594, 595		\$40	

\* Class will count as first round of the Low Adult Amateur Hunter Classic

### PIN OAK 3' HUNTER SECTION

Fences 3'. Judged on performance and soundness.

Pin Oak Hunter U/S	527	\$100	\$40	Ribbons
Pin Oak Hunter 3'	528, 529		\$40	

### PIN OAK 2'9" HUNTER SECTION

Fences 2'9". Judged on performance and soundness.

Pin Oak Hunter U/S	626	\$100	\$40	Ribbons
Pin Oak Hunter 2'9"	627, 628		\$40	

### PIN OAK 2'6" HUNTER SECTION

Fences 2'6". Judged on performance and soundness.

Pin Oak Hunter U/S	406	\$100	\$40	Ribbons
Pin Oak Hunter 2'6"	407, 408		\$40	

### PIN OAK 2'3" HUNTER SECTION

Fences 2'3". Judged on performance and soundness.

Pin Oak Hunter U/S	854	\$100	\$40	Ribbons
Pin Oak Hunter 2'3"	855, 856		\$40	

### PIN OAK 2'" HUNTER SECTION

Fences 2'. Judged on performance and soundness.

Pin Oak Hunter U/S	851	\$100	\$40	Ribbons
Pin Oak Hunter 2'	852, 853		\$40	



CLASS	CLASS #	SECTION FEE	CLASS FEE	PRIZE MONEY
-------	---------	-------------	-----------	-------------

### BABY GREEN HUNTER SECTION

Fences 2'6". Open to horses/ponies in their first two years of showing.

Baby Green Hunter U/S	581	\$160	\$40	Ribbons
Baby Green Hunter	582, 583, 584, 585		\$40	

### FIVE YEAR OLD & UNDER YOUNG HUNTER SECTION

Fences 2'9". Not to jog. Horses must be age verified with USEF.

Five Year Old & Under Young Hunter U/S	801	\$100	Section Entry Only	Ribbons
Five Year Old & Under Young Hunter	802, 803			

### SIX YEAR OLD & UNDER YOUNG HUNTER SECTION

Fences 3'. Not to jog. Horses must be age verified with USEF.

Six Year Old & Under Young Hunter U/S	806	\$100	Section Entry Only	Ribbons
Six Year Old & Under Young Hunter	807, 808			

### SEVEN YEAR OLD & UNDER YOUNG HUNTER SECTION

Fences 3'3". Not to jog. Horses must be age verified with USEF.

Seven Year Old & Under Young Hunter U/S	811	\$100	Section Entry Only	Ribbons
Seven Year Old & Under Young Hunter	812, 813			

### HOPEFUL HUNTER SECTION

Fences 2'6".

Hopeful Hunter U/S	586	\$160	\$40	Ribbons
Hopeful Hunter	587, 588, 589, 590		\$40	

### SHORT, MEDIUM & LONG STIRRUP HUNTER SECTION

Fences 18" - 24", no oxers. Open to riders in their first two (2) show seasons at USEF Regular Members Shows mounted on horses or ponies. Horse/rider combinations may not cross enter into any other classes at the same show. Manners shall be emphasized and extreme speed will be penalized.

#### SHORT STIRRUP HUNTER - RIDERS 12 & UNDER

Short Stirrup Hunter U/S	701	\$160	\$40	Ribbons
Short Stirrup Hunter	702, 703, 704, 705		\$40	

#### MEDIUM STIRRUP HUNTER - RIDERS 13 - 17

Medium Stirrup Hunter U/S	706	\$160	\$40	Ribbons
Medium Stirrup Hunter	707, 708, 709, 710		\$40	

#### LONG STIRRUP HUNTER - 18 & OVER

Long Stirrup Hunter U/S	711	\$160	\$40	Ribbons
Long Stirrup Hunter	712, 713, 714, 715		\$40	

#### SHORT, MEDIUM, LONG STIRRUP HUNTER WARM UP

S/M/L Stirrup Hunter Warm Up U/S	857	\$100	\$40	Ribbons
S/M/L Stirrup Hunter Warm Up	858, 859		\$40	

CLASS	CLASS #	SECTION FEE	CLASS FEE	PRIZE MONEY
-------	---------	-------------	-----------	-------------

### WALK TROT HUNTER SECTION

USEF MEMBERSHIP EXEMPT Open to riders on horses/ponies. Riders may not cross enter into any other classes, except opportunity classes. Manners shall be emphasized and extreme speed will be penalized. Week One Friday; Week Two and Three Saturday

Walk Trot Hunter	741	Class Entry Only	\$25	Ribbons
Walk Trot Hunter Poles	742, 743		\$25	

### WALK TROT HORSEMANSHIP SECTION

USEF MEMBERSHIP EXEMPT Open to riders on horses/ponies. Riders may not cross enter into any other classes, except opportunity classes. Manners shall be emphasized and extreme speed will be penalized. Week One Saturday; Week Two and Three Sunday

Walk Trot Horsemanship	746	Class Entry Only	\$25	Ribbons
Walk Trot Horsemanship Poles	747, 748		\$25	

### OPPORTUNITY SECTION

USEF MEMBERSHIP EXEMPT Open to riders on horses/ponies. Riders may not cross enter into any other classes, except walk/trot classes. Riders who have participated in USEF rated divisions/classes and /or zone points classes are ineligible for opportunity classes. To be judged on Horsemanship attributes of the rider. The attributes include, but are not limited to control of mount, appropriate pace, steering and effective position, Manners shall be emphasized and extreme speed will be penalized. See USEF GR821.

#### PIN OAK OPPORTUNITY WALK/TROT/CANTER HUNTER - Saturday

Pin Oak Opportunity Walk/Trot/Canter Hunter	716	Class Entry Only	\$25	Ribbons
Pin Oak Opportunity X-Rails Hunter	717, 718		\$25	

#### PIN OAK OPPORTUNITY WALK/TROT/CANTER 18" HUNTER - Saturday

Pin Oak Walk/Trot/Canter Hunter	719	Class Entry Only	\$25	Ribbons
Pin Oak Walk/Trot/Canter 18" Hunter	720, 721		\$25	

#### PIN OAK OPPORTUNITY WALK/TROT/CANTER HORSEMANSHIP - Sunday

Pin Oak Opportunity Walk/Trot/Canter Horsemanship	726	Class Entry Only	\$25	Ribbons
Pin Oak Opportunity X-Rails Horsemanship	727, 728		\$25	

#### PIN OAK OPPORTUNITY WALK/TROT/CANTER 18" HORSEMANSHIP - Sunday

Pin Oak Walk/Trot/Canter Eq. Horsemanship	729	Class Entry Only	\$25	Ribbons
Pin Oak Walk/Trot/Canter 18" Horsemanship	730, 731		\$25	

### HUNTER BREEDING SECTION

Horses to be judged on conformation, way of moving, quality, substance, soundness and suitability to become or in the case of sires and dams apparent ability to produce or beget hunters. Transmissible unsoundness is only to be considered in cases of sires and dams or prospective sires and dams. Yearlings, Two Year olds and Three Year olds are to walk and jog before being moved on the line in order of preference. First and second place winners in their respective classes may return for Best Young Horse. Hunter Breeding day of stall \$100; ship in \$75

Yearlings	656	Class Entry Only	\$30	Ribbons
Two Year Olds	657		\$30	
Three Year Olds	658		\$30	
Best Young Horse	659		None	

The mission of Candlelighters is to provide emotional, educational, and practical support to families of children with cancer; because no family should face childhood cancer alone.



**Candlelighters**  
CHILDHOOD CANCER FAMILY ALLIANCE

***Candlelighters thanks our friends at The Pin Oak Charity Horse Show for their support!***



12919 Southwest Freeway | Suite 100  
Stafford, TX 77477  
(713) 270-4700 | [candle.org](http://candle.org)







CLASS	HEIGHT	CLASS #	CLASS FEE	PRIZE MONEY
-------	--------	---------	-----------	-------------

### HUNTER CLASSICS & SPECIAL CLASSES

To be scored under the open numerical judging system. First round qualifying class will be the designated trip on the first day of the division. The top twelve (12) will return for their second round the second day.. Scores will be added together from both rounds to determine placing. Ribbons 1-8, unless otherwise noted. All ribbon winners must ride for awards. Formal attire requested. Horses not to jog. Specs per HU174

Pin Oak Children's Hunter Classic 14 & Under, NAL/WIHS	3'	675	\$100	\$1,000
Pin Oak Children's Hunter Classic 15-17, NAL/WIHS	3'	676	\$100	\$1,000
Pin Oak Adult Amateur Hunter Classic, NAL/WIHS	3'	679	\$100	\$1,000
Children's Hunter Pony Classic	per division	677	\$50	\$500
Low Children's Hunter Classic	2'6"	683	\$50	\$500
Low Adult Amateur Hunter Classic	2'6"	684	\$50	\$500
Pony Hunter Classic	per division	680	\$150	\$1,500
Green Pony Hunter Classic	per division	678	\$100	\$1,000
3'6" Junior Hunter Classic	3'6"	685	\$100	\$1,000
3'3" Junior Hunter Classic	3'3"	686	\$100	\$1,000
3'6" Amateur Owner Hunter Classic	3'6"	687	\$100	\$1,000
3'3" Amateur Owner Hunter Classic	3'3"	688	\$100	\$1,000
Texas Green Hunter Super Stake * 3' or 3'3"	per division	1455	\$275	\$2,500
Texas Performance Hunter Super Stake * 3'3" or 3'6"	3'6"	1435	\$125	\$1,000
USHJA Incentive Stake * 3' or 3'3"	per division	2455	\$100 + \$20	\$1,000
USHJA Incentive Stake * 3'6" or 3'9"	per division	1420	\$100 + \$20	\$1,000
USHJA National Hunter Derby - Week One and Two Only	3' - 3'3"	681	\$400 + \$35	\$10,000
USHJA National Hunter Derby - Week Three Only	3'-3'3"	681	\$500 + \$35	\$15,000
USHJA International Hunter Derby - Week One and Three Only	3'6"-4'6"	682	\$800 + \$50	\$30,000
Open Hunter Classic - Week Two Only	3'6", 3'9", 4'	690	\$700	\$25,000

**\* Attention Exhibitors:** See time schedule for which classes will count for the USHJA Incentive Stakes and the Texas Hunter Super Stakes. Please note that the horse must enter the USHJA Incentive and the Texas Super Stake separately from their hunter sections.

### TEXAS HUNTER SUPER STAKES

Horses must be enrolled in the Texas Super Stake Series in order to compete. To be judged on performance, soundness, suitability and manners. To be scored under the open numerical system. Each competitor will jump one round of approximately 10 jumps. Participants must enter and declare fence heights in the show office, by entry closing time the day prior to the Super Stake class. Conducted in accordance with HU106.3

Class 1455 - Green 3' or 3'3" - \$2500 prize money and 30% of entry fees paid out

Class 1435 - Performance 3'3" or 3'6" - \$1000 prize money and 30% of entry fees paid out

**Featuring.....End of the Year Finals & Series Year End Awards for riders, horses and owners!**

Prize money paid as follows:

1st	2nd	3rd	4th	5th	6th	7th	8th
30%	22%	15%	10%	7%	6%	5%	5%

### \$1,000 USHJA GREEN HUNTER INCENTIVE STAKE

Open to horses of any age that are eligible to compete as a Green Hunter under Federation rules. Horses must be enrolled in the USHJA Incentive Program and pay the annual enrollment fee to participate in the Green Stake classes and to be eligible for the USHJA Incentive. Additionally, horse must be registered with USHJA and recorded with USEF to participate. Only horses appearing on the enrolled list located at [www.ushja.org](http://www.ushja.org) are eligible to compete in a USHJA Incentive class. Horses may only be enrolled online. If a horse is enrolled during a competition, the horse's enrollment date will be considered the first day of the competition at which it was enrolled. Horses may be ridden by a Professional, Junior or Amateur. There is no limit to the number of horses a rider may compete in the class. A minimum of eight obstacles must be offered in the class. Fences 3' or 3'3" OR 3'6" or 3'9". To be judges on quality, movement, jumping style, manners and way of going using the open numerical scoring system. A score will be announced after each round and horses are not required to jog for soundness.

Prize money paid as follows: \$50 of each entry fee will be added to the total amount of prize money

1st	2nd	3rd	4th	5th	6th	7th	8th	9th	10th	11th	12th
30% of addback	22% of addback	13% of addback	8% of addback	6% of addback	5% of addback	4% of addback	3% of addback	3% of addback	2% of addback	2% of addback	2% of addback

### USHJA NATIONAL HUNTER DERBY

Class entry due by 4:00 p.m. the day before.

Open to all eligible horses. Each horse/rider combination must complete a USHJA Exhibitor Declaration Form for HOTY bonus points to be awarded. Points accrued by horses shown by Professionals may be awarded to the declared Green 3' or 3'3" section, Performance 3'3" or Small Hunter. Points accrued by horses shown by Juniors or Amateurs may be awarded to the declared Green 3' or 3'3" section, Performance 3'3", applicable Children's, Pony, Adult Amateur or Amateur Owner 3'3" section, Small Hunter or Junior Hunter 3'3". Zone bonus points to be awarded per USHJA Rules. Riders, owners and trainers must be active current members of the USEF and USHJA before the start of the class. Horses must be registered with USHJA and recorded with USEF.

The order of go will be drawn and posted a minimum of one (1) hour prior to the start of the class. Horses will not jog for soundness. Formal attire required.

Round One: Hunter Classic Course - there will be a minimum of 10 obstacles. Fences set at 3', with four option fences set at 3'5". Judged on performance, hunter pace and style, quality and substance, movement and brilliance. After the score is given, one point will be added for each high option fence jumped without major fault (maximum of four points).

Round Two: Handy Hunter Course - there will be a minimum of eight obstacles. Fences set at 3', with four option fences set at 3'5". Judged on performance, hunter pace and jumping style, quality and substance, movement, handiness and brilliance of pace. After the score is given, one point will be added for each high option fences jumped without major fault (maximum of four points).

The top 12 horses from the first round will return in reverse order of score for the second round; lowest score returning first.

Each class may have the option of having either one (1) or two (2) panels of judges. Each panel will consist of two (2) judges sitting together. One (1) judge on each panel must be a "R" judge, the other judge on each panel may be either a "R" or "r" judge. Each panel will provide one (1) score for each round. No panel may award the same base score to any two (2) competitors in any one round unless a competitor's score is below the cut-off score. A numerical score must be given and may be a duplicate score if it is under the cut-off.

Ties: All ties in all rounds will be broken using the base score (before adding height bonus points) of that round. All ties for overall first place will compete in a jump off round. Ties for other than first place in the overall standing will be broken using the second round base score (before adding height bonus).

Complete specs available at [www.ushja.org](http://www.ushja.org)

Horses may not compete in both the USHJA National and International Derbies at the same show.

Prize money paid as follows for weeks one and two - \$10,000

1st	2nd	3rd	4th	5th	6th	7th	8th	9th	10th	11th	12th
\$3,000	\$2,200	\$1,300	\$800	\$600	\$500	\$400	\$300	\$300	\$200	\$200	\$200

Prize money paid as follows for week three - \$15,000

1st	2nd	3rd	4th	5th	6th	7th	8th	9th	10th	11th	12th
\$4,500	\$3,300	\$1,950	\$1,200	\$900	\$750	\$600	\$450	\$450	\$300	\$300	\$300



## USHJA INTERNATIONAL HUNTER DERBY

Class entry due by 4:00 p.m. the day before

Open to all eligible horses. Each horse/rider combination must complete a USHJA Exhibitor Declaration Form for HOTY bonus points to be awarded. Riders, owners and trainers must be active current members of the USEF and USHJA before the start of the class. Horses must be registered with USHJA, enrolled in the IHD program (Exception: horses may show in a maximum of one class in the series year without enrollment) and recorded (life or annual) with USEF. Horses must be on the competition grounds 24 hours prior to the start of the first round of the class and must remain on the show grounds until the completion of the class. All horses must be ridden in the designated schooling areas and back numbers must be worn on the horse at all times.

The order of go will be drawn and posted a minimum of one hour prior to the start of the first round. Draw may be by hand or computer. Formal Attire Required.

A two round class with a jump off round when necessary. Fence heights 3'6" to 4' with a maximum of 50% of the jumps set at 3'6" and a minimum of four 4' to 4'3" fences in each round set as option jumps. Tradition to be emphasized in the attire of both the riders and the horses. Horse will show in traditional hunter tack, including snaffles, pelhams, double bridles & both running and standing martingales.

For Derbies with \$49,999 or less in prize money, a minimum of two (2) R-licensed judges are required. Judges will be seated separately, giving an individual score for both phases. The scores from each judge will be added together for the total score.

Round One: Hunter Classic Course - to be shown over a hunter classic type course consisting of a minimum of 10 fences/obstacles that simulate those reminiscent of the hunt field and a variety of derby jumps will be used. To be judged on performance, hunter pace and style, quality and substance, movement and brilliance.

Horses are to trot a circle on a loose rein at the end of their first round.

Ties in the first round will remain tied. The top 12 horses after the first round, including ties, will return for the second round.

Round Two: - Handy Hunter Course - to be shown over a minimum of eight obstacles and will include a minimum of three required "handy options." To be judges on style, brilliance and handiness.

All ties for overall first place may compete in a Jump Off Round at the discretion of the owners and riders. If a tie occurs after the Jump Off Round, OR if both exhibitors agree NOT to jump off, the exhibitors will be named co-winners, will evenly split the prize money. Tied entrants must determine the distribution of awards amongst themselves. If one of the tied exhibitors declines to jump off, that exhibitor must sign a forfeiture agreement which will be provided to them at the time of the jump off. All other placings will remain tied.

Complete specs available at [www.ushja.org](http://www.ushja.org) Derby will follow Two Star Chart.

Horses may not compete in both the USHJA National and International Derbies at the same show.

Prize money paid as follows - \$30,000

1st	2nd	3rd	4th	5th	6th	7th	8th	9th	10th	11th	12th
\$9,000	\$6,600	\$3,900	\$2,400	\$1,800	\$1,500	\$1,200	\$900	\$900	\$600	\$600	\$600

## PIN OAK OPEN HUNTER CLASSIC

Class entry due by 4:00 p.m. the day before - WEEK TWO ONLY

Open to horses that have completed the course in at least two (2) over fences classes in the following sections: Green Conformation, High Performance Conformation, Green Hunter 3'6", Green Hunter 3'9", High Performance Hunter, Performance 3'6" Hunter, Amateur Owner 3'6" Hunter, Junior Hunter 3'6". Presidential Modification granted for junior hunters: Junior hunters must be entered in the Junior Hunter 3'6" section before the Open Hunter Classic. If a horse does not complete two (2) over fences classes in the Junior Hunter 3'6" Section, the horse will be eliminated from the Open Hunter Classic. Horse will jump the same height as the division they showed in during the show. If a horse is eligible for more than one section, they must declare their point section and height prior to the start of the classic in the show office. The order of go will be drawn and posted a minimum of one hour prior to the start of the first round. Draw may be by hand or computer. Formal Attire Required. Classic will be a two round hunter classic format with the top 12 horses returning for the second round. Scores from both rounds will be totaled to determine the winner. In the event of ties, the higher scored horse from round two will break the tie.

Prize money paid as follows - \$25,000

1st	2nd	3rd	4th	5th	6th	7th	8th	9th	10th	11th	12th
\$7,500	\$5,500	\$3,250	\$2,000	\$1,500	\$1,250	\$1,000	\$750	\$750	\$500	\$500	\$500



## Hunter Seat Equitation Division

### GENERAL CONDITIONS AND SPECIFICATIONS

All classes to be judged on seat, hands, guidance and control of the mount. See USEF Rule Book for Medal class specifications or check in the show office. Trophy & 8 Ribbons in all classes. Not all classes happen every week, please refer to weekly time schedule for class offerings.

Class	Flat #	Fence Height	Fences #	Entry Fee
Children's Equitation 14 & Under	750	3'	751, 752	\$45
Children's Equitation 15-17	753	3'	754, 755	\$45
Adult Amateur Equitation	756	3'	757, 758	\$45
Jr Equitation 14 & Under	771	3'	772, 773	\$45
Jr Equitation 15-17	768	3'6"	769, 770	\$45
Pony Equitation	759	per section	760	\$45
Children's Pony Equitation	774	per section	775	\$45
Low Children's Equitation	783	2'6"	784	\$45
Low Adult Amateur Equitation	762	2'6"	763	\$45
Short Stirrup Equitation	777	2'	778	\$45
Medium Stirrup Equitation	780	2'	781	\$45
Long Stirrup Equitation	765	2'	766	\$45
Leadline	30	-	-	n/a

Childrens Equitation - the same horse/rider combination may not enter any other class, equitation excepted, at the same show in which fence heights exceed 3'5".

Low Children's/Low Adult Amateur Equitation - open to riders in the Low Children or Low Adult Amateur Hunter Sections.

Short/Medium/Long Stirrup Equitation - open to riders showing in the Short, Medium or Long Stirrup Hunters.

Children's and Junior Equitation rider/horse combinations may not cross enter between heights.

ASPCA Maclay Horsemanship EQ111.6	3'6"	788	\$70
THIS Adult Amateur Medal - <a href="http://www.nhs.org">www.nhs.org</a>	3'	800	\$70
Hamel NHS 3'3" Medal - <a href="http://www.nhs.org">www.nhs.org</a>	3'3"	798	\$70
Dover Saddlery/US Hunter Seat Medal EQ111.3	3'6"	789	\$70
Platinum Performance USEF Show Jumping Talent Search 1* EQ111.7	3'9"	793	\$70
Marshall & Sterling US Pony Medal EQ111.4	per height	786	\$70
WIHS Equitation Hunter Phase EQ111.8	3'6"	790	\$70
WIHS Equitation Jumper Phase EQ111.8	3'6"	791	\$70
WIHS Pony Medal EQ111.8	per height	787	\$70
THIS National Children's Medal <a href="http://www.ryegate.com">www.ryegate.com</a>	3'	794	\$70
Ariat National Adult Medal <a href="http://www.ryegate.com">www.ryegate.com</a>	3'	797	\$70
EMO/USHJA Jumping Seat Medal <a href="http://www.ushja.org">www.ushja.org</a>	3'3"	792	\$70
USHJA Adult Jumping Seat Medal <a href="http://www.ushja.org">www.ushja.org</a>	3'3"	795	\$70
IHSA/USHJA Hunt Seat Medal <a href="http://www.ushja.org">www.ushja.org</a>	3'3"	785	\$70
THJA Mini Medal - <a href="http://www.thja.org">www.thja.org</a>	2'6"	799	\$70
WEC Premier Cup Qualifier <a href="http://www.ryegate.com">www.ryegate.com</a>	3'6"	796	\$70



# IRISH DAY FARM

HUNTERS • JUMPERS • DRESSAGE

HOUSTON, TEXAS

**Katie Lambert-Boone**

[www.irishdayfarm.com](http://www.irishdayfarm.com)

For more information contact Sam at: 908-209-5855



## Jumper Division

### GENERAL CONDITIONS AND SPECIFICATIONS

All jumper declarations are due by 4 p.m. the day prior to the class, unless otherwise noted. Nomination fee of \$200 is required for those classes listed in the nominated jumper section. Horses will only pay one nominating fee regardless of cross entry into money classes. Championships will be awarded in jumper sections that offer three or more classes not held at Table II. Champion and Reserve will be determined using the USEF bonus point system. Bonus Points will apply to the last class or highest money class. In the event of a tie for Champion or Reserve the bonus class placing (or participation) will break all ties. Riders should be properly attired. Proper Jumper Attire, jackets, are required for all classes in the Main Arena. Standard Jumper Attire is permitted for classes in other rings. It is the exhibitors responsibility to familiarize themselves with all pertinent current USEF rules and regulations for the Jumper division and jumper schooling areas. A 45 second count down clock will be used. Poling or offsets will not be permitted on the grounds. Ties for placing other than first place will be separated by time. Time allowed in accordance with USEF JP 129.

Not all classes are offered every week, please refer to time schedule for classes offered and for all jumper tables.

**HORSE SHOW ISSUED** number card must be worn on rider's back or on the saddle pad so that it is visible to the paddock master.

### NON-NOMINATED JUMPER CLASSES

Class Name	Height	Class #	Entry Fee	Prize Money
------------	--------	---------	-----------	-------------

#### Championships by height

0.60m Itty Bitty Jumper	0.60m	250, 251, 252	\$45	Ribbons
0.75m Jumper	0.75m	301,302, 303, 321, 327	\$45	Ribbons
0.85m Jumper	0.85m	304,305,306	\$45	Ribbons
0.90m Jumper	0.90m	307,308, 309	\$45	Ribbons
0.95m Jumper - no championship	0.95m	311,312	\$45	Ribbons
1.0m Jumper	1.0m	314, 315, 316, 317	\$45	Ribbons
1.05m Jumper - no championship	1.05m	318, 319	\$45	Ribbons

#### 1.10m JUMPER (championship will not include any Table II classes)

1.10m Jumper	1.10m	322,323, 326	\$50	\$250
1.10m Jumper	1.10m	324	\$100	\$1000
1.10m Jumper (no champ points)	1.10m	325	\$45	-

#### 1.15m JUMPER

1.15m Jumper	1.15m	329, 330	\$50	\$250
1.15m Jumper	1.15m	331	\$100	\$1000

### MODIFIED JUNIOR/AMATEUR JUMPER

Horses in this section must be ridden by junior or amateur riders. Same requirements as 1.0m Jr/Am jumpers.

Modified Junior/Amateur Jumper	0.90m	378, 379, 380	\$45	Ribbons
--------------------------------	-------	---------------	------	---------

Class 380 will receive bonus points for show championship.

### \$300 TAKE 2 THOROUGHBRED JUMPER

Open to thoroughbred horses who's registration can be verified by one of the following methods: Jockey club certificate of foal registration, horse's lip tattoo and 5-cross pedigree lookup results from the Jockey Club, Letter from the Jockey Club verifying the horse's identity. A minimum of 3 entries are required to fill.

Take 2 TB Jumper	1.00m	384, 385, 386	\$45	\$100
------------------	-------	---------------	------	-------





Class Name	Height	Class #	Entry Fee	Prize Money
------------	--------	---------	-----------	-------------

**\$3,000 YOUNG JUMPER**  
**Sponsored by SHF Enterprises**

To be run in accordance with USEF rules. Horses must be recorded with USEF to participate in any young jumper classes. Horses must be age verified with USEF.

Five Year Old Jumper-Speed 325m/m	1.10m	357, 358, 359 (1.15m)	\$45	Ribbons
Six Year Old Jumper	1.20m	360, 361, 362	\$60	\$500
Seven Year Old Jumper	1.30m	363, 364, 365	\$60	\$500

**\$4,000 1.0m JUNIOR/AMATEUR JUMPER**

Classes at the same height may be combined if less than 6 entries.

**1.0m AMATEUR JUMPER**

Open to Amateur riders. Run in accordance with Zone 7 specs.

1.0m Amateur Jumper	1.00m	366, 367	\$50	\$250
1.05m Amateur Jumper Stake - Week One and Two Only	1.05m	368	\$125	\$1,500

Class 368 will receive bonus points for show championship.

**1.0m JUNIOR JUMPER**

Open to Junior riders. Run in accordance with Zone 7 specs.

1.0m Junior Jumper	1.00m	369, 370	\$50	\$250
1.05m Junior Jumper Stake - Week One and Two Only	1.05m	371	\$125	\$1,500

Class 371 will receive bonus points for show championship.

1.05m Junior/Amateur Jumper Classic - Week Three Only	1.05m	381	\$275	\$5,000
--	-------	-----	-------	---------

Class 381 will receive bonus points for show championship.

**\$6,000 1.10m JUNIOR/AMATEUR JUMPER**

Classes at the same height may be combined if less than 6 entries.

**1.10m AMATEUR JUMPER**

Open to Amateur riders. Run in accordance with Zone 7 specs.

1.10m Amateur Jumper	1.10m	372, 373	\$60	\$500
1.15m Amateur Jumper Classic-NAL/WIHS -Week One and Two Only	1.15m	374	\$150	\$2,000

Class 374 will receive bonus points for show championship.

**1.10m JUNIOR JUMPER**

Open to Junior riders. Run in accordance with Zone 7 specs.

1.10m Junior Jumper	1.10m	375, 376	\$60	\$500
1.15m Junior Jumper Classic - NAL/WIHS -Week One and Two Only	1.15m	377	\$150	\$2,000

Class 377 will receive bonus points for show championship.

1.15m Junior/Amateur Jumper Classic NAL/ WIHS - Week Three Only	1.15m	382	\$300	\$10,000
--	-------	-----	-------	----------

Class 382 will receive bonus points for show championship.

Class Name	Height	Class #	Entry Fee	Prize Money
------------	--------	---------	-----------	-------------

### NOMINATED JUMPER CLASSES

#### 1.20M JUNIOR JUMPER & AMATEUR JUMPER

##### 1.20m JUNIOR JUMPER

Open to Junior riders.

1.20m Junior/Amateur Jumper	1.20m	348, 349	\$65	\$750
1.25m Junior/Amateur Jumper Classic - NAL - Week One and Two Only	1.25m	350	\$275	\$5,000
1.25 Jr/Am Jumper Classic - NAL - Week Three Only	1.25m	350	\$300	\$10,000

Class 350 will receive bonus points for show championship.

#### 1.30/1.40M JUNIOR JUMPER & AMATEUR JUMPER

##### 1.30/1.40m JUNIOR JUMPER

Open to Junior riders. If there are more than 8 horses at each height the classes will be split.

1.30/1.40m Junior/Amateur Jumper	1.30/1.40m	351, 352	\$75	\$1,000
1.30/1.40m Junior/Amateur Jumper Classic - Week One and Two Only	1.30/1.40m	353	\$300	\$10,000
1.30/1.40m Jr/Am Jumper Classic - Week Three Only	1.30/1.40m	353	\$425	\$15,000

Class 353 will receive bonus points for show championship.

#### OPEN JUMPER

##### 1.20m JUMPER

1.20m Jumper	1.20m	333, 334	\$60	\$500
1.20m Jumper Stake	1.20m	335	\$275	\$5000

##### 1.30m JUMPER

1.30m Jumper	1.30m	336, 337	\$65	\$750
1.30m Jumper Stake	1.30m	392	\$275	\$5,000

##### 1.35m JUMPER

1.35m Jumper	1.35m	387, 388	\$75	\$1,000
--------------	-------	----------	------	---------

##### 1.40m JUMPER

1.40m Jumper	1.40m	390	\$75	\$1,000
--------------	-------	-----	------	---------



U25 Challenge * - Weeks One and Two	1.40m	395	\$275	\$5,000
U25 Grand Prix * - Weeks One and Two	1.40m	399	\$300	\$10,000
Open Jumper Welcome Stake - Week One and Two Only	1.40m	393	\$300	\$10,000
Open Jumper Welcome Stake - Week Three Only	1.40m	393	\$425	\$15,000
Pin Oak Grand Prix I (American Standard)* - Week One & Two Only	1.40m	396	\$500	\$25,000
Pin Oak Grand Prix I (National Standard) * - Week Three Only	1.50m	396	\$500+ IHP	\$25,000
Pin Oak Grand Prix II (American Standard) * - Week One Only	1.40m	398	\$600	\$30,000
Pin Oak Grand Prix II (National Standard) * - Week Two	1.50m	398	\$800+IHP	\$50,000
Pin Oak Grand Prix II (National Standard) * - Week Three	1.50m	398	\$1500+IHP	\$100,000

\* see additional specifications

### \$5,000 UNDER 25 WELCOME JUMPER STAKE

Table II 2b

Open to riders from the beginning of the calendar year in which they reach the age of 16 until the end of the calendar year in which they reach the age of 25. Amateur classification is not a factor for entry into a U25 class. Ties in the first round will be broken by time. Formal Jumper Attire Required.

### \$10,000 UNDER 25 GRAND PRIX

Class entry due by Friday 4 p.m.

Table II 2a

Open to riders from the beginning of the calendar year in which they reach the age of 16 until the end of the calendar year in which they reach the age of 25. Amateur classification is not a factor for entry into a U25 class. Ties in the first round will be broken by time. Formal Jumper Attire Required.

Prize money paid as follows:

1st	2nd	3rd	4th	5th	6th	7th	8th	9th	10th	11th	12th
\$3,000	\$2,000	\$1,000	\$700	\$600	\$500	\$450	\$400	\$400	\$350	\$300	\$300



# BAYBRIDGE



### PIN OAK GRAND PRIX I

Class entry due by 4 p.m. day before the class

Week One and Two - American Standard; Week Three - National Standard

Table II 2a

Open to nominated horses. Horse must be entered in at least one other nominated class at this show to be eligible. Standing martingales are prohibited. Within the 24 hour period prior to the class; horses must display their official show number whenever out of their stall and schooling is restricted to the designated schooling area and times. Ties in the first round will be broken by time. Formal Jumper Attire Required.

### PIN OAK GRAND PRIX II

Class entry due by 4 p.m. day before the class

Week One - American Standard; Week Two and Three - National Standard

Table II 2a

Open to nominated horses. Horse must be entered in at least one other nominated class at this show to be eligible. USEF Computer List rules in effect. Standing martingales are prohibited. Within the 24 hour period prior to the class; horses must display their official show number whenever out of their stall and schooling is restricted to the designated schooling area and times. Ties in the first round will be broken by time. Formal Jumper Attire Required. IHP Fee of \$35 will be collected per USEF GR207 during weeks 2 and 3.

Grand Prix Prize money paid as follows:

1st	2nd	3rd	4th	5th	6th	7th	8th	9th	10th	11th	12th
30%	22%	13%	8%	6%	5%	4%	3%	3%	2%	2%	2%

Please visit [ryegate.com/uset.php](http://ryegate.com/uset.php) Upcoming Classes to determine which classes will be included in the Rolex Computer Ranking List.





# Care, Compassion, and Commitment

## Your horses, our passion.

At Brazos Valley Equine Hospital, your goal is our goal. We are committed to provide high quality care from conception through retirement. Our highly skilled equine specialists strive to exceed expectations and help each horse reach its full athletic potential.



Navasota  
(936)825-2197

Navasota Breeding  
Division  
(936)727-7898

Cypress  
(281)255-2280

[bveh.com](http://bveh.com)



# MARCH 26 – APRIL 13, 2025

GREAT SOUTHWEST EQUESTRIAN CENTER  
KATY, TEXAS

## STALL, SHAVINGS, HAY, FEED & RV REQUEST FORM

Closing date: March 8  
Week I, Week II & Week III

### ATTENTION ALL TRAINERS

- Completing this form assures shavings, hay and feed will be delivered to your assigned stalls before your arrival.
  - Whole pallet (45 bags) shavings orders receive priority delivery. No returns.
  - The accurate completion and prompt return of this form is essential in assuring your barn of reserved stabling.
  - Stall & RV placement is given priority by level of sponsorship. \$10K+ sponsors are guaranteed Premier placements.
- All changes after the horse show begins for shavings, hay and feed must be made in the show office.

**ALL FIELDS MUST BE COMPLETED AND FORM MUST BE SIGNED.**

BARN NAME \_\_\_\_\_

TRAINER'S NAME \_\_\_\_\_

CELL PHONE \_\_\_\_\_

EMAIL \_\_\_\_\_

EXPECTED ARRIVAL DATE \_\_\_\_\_

### YOU MUST FILL OUT A STALL RESERVATION FORM TO RESERVE STALLS

	TOTAL # OF HORSE STALLS	TOTAL # OF TACK STALLS	TOTAL # OF SHAVINGS	HAY / FEED Note: Coastal, Timothy, Orchard or Alfalfa	TOTAL # OF PREMIER RV SPOTS 30 / 50 AMP	TOTAL # OF RV SPOTS ORIGINAL SECTION 30 / 50 AMP
PREVIEW						
WEEK I						
WEEK II						
WEEK III						

SIGNATURE \_\_\_\_\_ DATE \_\_\_\_\_

### PLEASE SEND YOUR FORM PRIOR TO THE HORSE SHOW TO:

**Pin Oak Charity Horse Show**  
Attn: Sara Turriago  
2501 S. Mason Road • Suite 100  
Katy, Texas 77450

**Email** sturriago@gshec.com  
**Fax** 281-578-6651  
**Questions** Sara Turriago • 914-602-2693



# The Pin Oak

## ANNUAL GROOMS PARTY

SPONSORED BY VICKI HUNTON, OLDE OAKS FARM



Teamwork makes the dream work!

Join us in supporting the heroes  
- The Grooms of Pin Oak -  
*in memory of longtime Groom's Party  
supporter Charlotte Hunton.*

*Tuesday, April 1, 2025*

6 - 8 PM - RIDER'S LOUNGE

Every penny goes towards  
making this event *Fantastic* for our deserving grooms!

Please **Venmo** @victoria-hunton or **PayPal** @victoriahunton1 with your donation.



## **Faust Distributing Company**

Faust Distributing Company is one of the largest family-owned wholesale beer distributors in Texas and one of the largest independent distributors of Miller Brewing Company and Coors Brewing Company products in the United States as well as a vast portfolio of imported and craft beers, hard seltzers, spirits and non-alcoholic products.

10040 East Freeway, Houston, TX 77029  
(713) 673-5111  
[www.faustdistributing.com](http://www.faustdistributing.com)

# RIO AGAVE

SPARKLING  
RANCH WATER



MADE WITH  
REAL TEQUILA



FIND RIO  
AGAVE

100%  
Premium  
Blanco Tequila

2  
Carbs

0  
Sugar

7.0%  
ABV





REDEFINING PRIVATE FLIGHT | A BETTER | SMARTER | FASTER EXPERIENCE

WITH **OSPREYJETS**, EVERY FLIGHT GOES BEYOND TRANSPORTATION. ENJOY 24/7 SERVICE, COMPETITIVE PRICING WITHOUT UP-FRONT COMMITMENTS, AND PERSONALIZED CARE FROM A DEDICATED TEAM MEMBER WHO KNOWS YOUR PREFERENCES AND HANDLES ALL YOUR NEEDS.

EXPERIENCE SEAMLESS TRAVEL, COMFORT, AND EXCEPTIONAL SERVICE—EVERY TIME.



**FLY. BUY. SELL—OSPREYJETS—**  
WHERE LUXURY MEETS EXPERTISE  
IN PRIVATE JET TRANSACTIONS



[www.ospreyjets.com](http://www.ospreyjets.com)



## WEDNESDAY - MARCH 26

**Main Indoor Ring - 7:30 am**  
 325 **Austin A.I.** 1.10m Jumper II  
 357 1.10m 5 YO Jumper II  
 329 1.15m Jumper II 2d(\$250)  
 333 1.20m Jumper II 2d(\$500)  
 360 1.20m 6 YO Jumper II 2d(\$500)  
 363 1.30m 7 YO Jumper II 2d(\$500)  
 336 1.30m Jumper II 2d(\$750)  
 387 1.35m Jumper II 2d(\$1000)

**Not Before 4:00 pm**  
 393 **Irish Day Farm** 1.40m  
**Welcome Stake II 2b(\$10,000)**  
 395 **1.40 U25 Welcome II 2b(\$5000)**  
 (concurrent with Welcome)

**Grand Prix Check In: 3-4 pm**  
**Main Indoor Arena Warm-Up Ring**

**Tellepsen Arena - 8:00 am**  
 301 0.75m Jumper II, 2d  
 304 0.85m Jumper II, 2d  
 307 0.90m Jumper II, 2d  
 311 0.95m Jumper II, 2d  
 314 1.0m Jumper II 2d  
 384 **Sam Houston Race Park**  
 1.0m Take 2 TB Jum II 2d(\$100)  
 318 1.05m Jumper II 2d  
 322 1.10m Jumper II 2d(\$250)

**ESI Ring**  
**Ticketed Warm Up 8am- 12 noon**  
**not before 12:30 pm**  
 656 Yearling HB  
 657 Two Year Old HB  
 658 Three Year Old HB  
 659 **Salata** Best Young Horse  
**1:30 pm**  
 807-808 3' Young Hunter (6 & U)  
 806 3' Young Hunter U/S (6 & U)  
 802-803 2'9" Young Hunter (5 & U)  
 801 2'9" Young Hunter U/S (5 & U)

**Mega Ring 1 - 7:30 am**  
 400 Green Conformation Model  
 410 HP Conformation Model  
 427-428 High Performance Hunter  
 426 High Performance Hunter U/S  
 412-413 HP Conformation Hunter  
 411 HP Conformation Hunter U/S  
 422-423\* 3'9" Green Hunter  
 1420 USHJA Green Incentive 3'6"/3'9"  
 (concurrent w/423 & 418)  
 421 3'9" Green Hunter U/S  
 417-418\* 3'6" Green Hunter  
 416 3'6" Green Hunter U/S  
 402-403 Green Conformation Hunter  
 401 Green Conformation Hunter U/S  
 432-433\* 3'6" Performance Hunter  
 431 3'6" Performance Hunter U/S  
 437-438\* 3'3" Performance Hunter  
 436 3'3" Performance Hunter U/S  
**1435 GSS, The Marketing Agency**  
**TX 3'3"/3'6" Performance Stake**

**Mega Ring II - 8:00 am**  
 457-458 **Lynn & Pete Walsh**  
 3'3" Green Hunter  
 456 **Lynn & Pete Walsh**  
 3'3" Green Hunter U/S  
 812-813 3'3" Young Hunter (7 & U)  
 811 3'3" Young Hunter U/S (7 & U)  
 452-453 3' Green Hunter  
 451 3' Green Hunter U/S

**Sand Ring - 8:00 am**  
 407-408 2'6" Pin Oak Hunter  
 582-583 2'6" Baby Green Hunter  
 406 2'6" Pin Oak Hunter U/S  
 672-673 3' Take 2 TB Hunter  
 671 **Par Avion LTD**  
 Take 2 TB Hunter U/S

**Wheless Arena - Ticketed Warm Up**  
**9:00 am - 5:00 pm**

## THURSDAY - MARCH 27

**Main Indoor Ring - 8:00 am**  
 326 1.10m Jumper II 1(\$250)  
 358 1.10m 5 YO Jumper II  
 330 1.15m Jumper II 1(\$250)  
 334 1.20m Jumper II 1(\$500)  
 361 **Empire Med Spa**  
 1.20m 6 YO Jumper II 1(\$500)  
 364 1.30m 7 YO Jumper II 1(\$500)  
 337 1.30m Jumper II 1(\$750)  
 388 1.35m Jumper II 1(\$1000)

**Not Before 4:00 pm**  
 396 **Wentz Family Foundation**  
**\$25,000 Pin Oak Charity Grand Prix**  
**- American Standard**  
 399 **1.40m U25 Grand Prix II 2a(\$10,000)**  
 (concurrent with GP)

**International Derby Check In : 2-3 pm**  
**Main Indoor Arena Warm-Up Ring**

**Tellepsen Arena - 8:00 am**  
 302 0.75m Jumper II, 2b  
 305 0.85m Jumper II, 2b  
 308 0.90m Jumper II, 2b  
 312 0.95m Jumper II, 2b  
 315 1.0m Jumper II 2b  
 385 **Quail Hollow Tack**  
 1.0m Take 2TB Jump II 2b(\$100)  
 319 1.05m Training II 2b  
 323 1.10m Training II 2b(\$250)

**ESI Ring - 8:00 am**  
 581 Baby Green Hunter U/S  
 587-588 2'6" Hopeful Hunter  
 584-585 2'6" Baby Green Hunter  
 592-593+ Low AA Hunter

**Mega Ring I - 8:00 am**  
 429H-430 **Perfect Products**  
 High Performance Hunter  
 414H-415 HP Conformation Hunter  
 424H-425 3'9" Green Hunter  
 419H-420 3'6" Green Hunter  
 404H-405 Green Conformation Hunter  
 434H-435 3'6" Performance Hunter  
 439H-440 3'3" Performance Hunter  
 462-463+ 3'6" AO Hunter 18-35  
 467-468+ 3'6" AO Hunter 36 & Over  
**Sand Ring - 8:00 am**  
 757 Adult Eq - Fences  
 502-503+ AA Hunter 50 & Over  
 501 AA Hunter 50 & Over U/S  
 507-508+ AA Hunter 36-49  
 506 AA Hunter 36-49 U/S  
 512-513+ AA Hunter 18-35  
 511 AA Hunter 18-35 U/S  
 756 Adult Eq - Flat  
 627-628 2'9" Pin Oak Hunter  
 626 2'9" Pin Oak Hunter U/S

**Mega Ring II - 8:00 am**  
 454-455\* 3' Green Working Hunter  
 1455 Texas Green Hunter Stk 3'/3'3"  
 2455 USHJA Green Incentive 3'/3'3"  
 (concurrent w/455 & 460)  
 459-460\* 3'3" Green Working Hunter  
 472-473+ 3'3" AO Hunter 18-35  
 477-478+ 3'3" AO Hunter 36 & Over

**Wheless Arena - Ticketed Warm Up**  
**9:00 am - 5:00 pm**

\* TX Hunter Stake and/or USHJA Incentive  
 + First Round of Classic  
 H Handy  
 C Conformation

## FRIDAY - MARCH 28

**Main Indoor Ring - 8:00 am**  
 324 **The Maestas Family**  
 1.10m Jumper II 2b(\$1000)  
 331 1.15m Jumper II 1 (\$1000)  
 359 1.15m 5 Year Old Jumper II  
 335 1.20m Jumper II 2b (\$5000)  
 362 1.20m 6 Year Old Jumper II 2b(\$500)  
 365 1.30m 7 Year Old Jumper II 2b(\$500)  
 392 **Bedoya Training Stables**  
**1.30m Jumper Stake II 1 (\$5000)**  
 390 1.40m Jumper II 2b (\$1000)  
 351 **The Wiesner Family**  
 1.30/1.40m Jr/Am Jump II 2d (\$1000)  
 348 1.20m Jr/Am Jumper II 2d (\$750)

**ESI Ring - 8:00 am**  
 589-590 2'6" Hopeful Hunter  
 586 2'6" Hopeful Hunter U/S  
 591 Low AA Hunter U/S  
 762 Low Adult Eq. - Flat  
 763 Low Adult Eq. - Fences  
 594-595 Low Adult Hunter

**684 Bailey Acres \$500 Low Adult**  
**Hunter Classic - 2nd Round**

**Tellepsen Arena - 8:00 am**  
 303 0.75m Jumper II 2d  
 306 0.85m Jumper II, 2d  
 378 0.90m Mod Jr/Am Jumper II 2d  
 316 1.0m Jumper II 2d  
 386 1.0m Take 2TB Jump II 2d(\$100)  
 366 1.0m Amateur Jump II 2d(\$250)  
 372 1.10m Amateur Jump II 2d(\$500)  
 375 1.10m Junior Jumper II 2d(\$500)

**Wheless Ring - 8:00 am**  
 855-856 2'3" Pin Oak Hunter  
 854 2'3" Pin Oak Hunter U/S  
 852-853 2' Pin Oak Hunter  
 858-859 2' S/M/L Stirrup Hunter Warm Up  
 851 2' Pin Oak Hunter U/S  
 857 2' S/M/L Stirrup Hunter Warm Up U/S

**Grand Prix Check In: 3-4 pm**  
**Main Indoor Arena Warm-Up Ring**

**Mega Ring I - 8:00 am**  
 471 3'3" AO Hunter 18-35 U/S  
 474-475H 3'3" AO Hunter 18-35  
 476 3'3" AO Hunter 36 & Over U/S  
 479-480H 3'3" AO Hunter 36 & Over  
**688 Black Mare Bootery**  
**3'3" \$1000 AO Hunter Classic**  
 2nd Round  
 461 3'6" AO Hunter 18-35 U/S  
 464-465H 3'6" AO Hunter 18-35  
 466 3'6" AO Hunter 36 & Over U/S  
 469-470H 3'6" AO Hunter 36 & Over  
**687 Memorial Park Hunters**  
**3'6" \$1000 AO Hunter Classic**  
 2nd Round

**Mega II Ring - 8:00 am**  
 758 Adult Eq - Fences (Open Card)  
 797 Ariat National Adult Medal  
 800 THIS NHS Adult Medal  
 504-505 **The Smith Sisters**  
 AA Hunter 50 & Over  
 509-510 AA Hunter 36-49  
 514-515 AA Hunter 18-35  
 679 **Stonewall Farm**  
 \$1000 NAL/WIHS AA Hunter  
 Classic 2nd Round  
 528-529 3' Pin Oak Hunter  
 527 3' Pin Oak Hunter U/S

**Sand Ring - 9:00 am**  
**681 Baybridge Hunter Jumpers**  
**\$10,000 USHJA National**  
**Hunter Derby**

**3:00 pm**  
**682 RC Ranch \$30,000 USHJA**  
**International Hunter Derby**

## SATURDAY MARCH 29

### Main Indoor Ring - 8:00 am

- 349 1.20m Jr/Am Jumper II 1(\$750)  
 352 **Lunch Money Sport Horses**  
 1.30/1.40m Jr/Am Jumper II 1(\$1000)  
 373 1.10m Amateur Jumper II 1(\$500)  
 376 1.10m Junior Jumper II 1(\$500)  
 795 USHJA 3'3" Adult Jumping Seat Medal  
 792 EMO USHJA 3'3" Jr. Jump Seat Medal  
 791 WIHS Equitation Jumper Phase

### Not Before 7:00 pm

- 30 **Susan Godfrey Leadline**  
 398 **WA Farm \$30,000 Pin Oak**  
**Charity Grand Prix - American Standard**

### Tellepsen Arena - 7:30 am

- 250 0.60m Jumper IV, 1  
 251 0.60m Jumper II 2d  
 321 0.75m Training Jumper IV, 1  
 309 0.90m Training Jumper II 2b  
 379 0.90m Mod. Jr/Am Jumper II 2b  
 369 1.0m Junior Jumper II 2d(\$250)  
 367 **Owens Realtors 1.0m Amateur**  
 Jumper II 2b(\$250)  
 370 1.0m Junior Jumper II 2b(\$250)

### ESI Ring - 8:00 am

- 597-598+ Low Children's Hunter  
 799 THJA Mini Medal

### Mega Ring I - 8:00 am

- 790 WIHS Equitation - Hunter Phase  
 482-483+ 3'6" Sm Jr Hunter 15 & U  
 481 3'6" Sm Jr Hunter 15 & U U/S  
 487-488+ 3'6" Sm Jr Hunter 16-17  
 486 3'6" Sm Jr Hunter 16-17 U/S  
 492-493+ 3'6" Lg Jr Hunter 15 & U  
 491 3'6" Lg Jr Hunter 15 & U U/S  
 497-498+ 3'6" Lg Jr Hunter 16-17  
 496 3'6" Lg Jr Hunter 16-17 U/S  
 789 **Cokin's Dover**  
 & US Hunter Seat Medal  
 798 Hamel NHS 3'3" Equitation  
 612-613+ 3'3" Jr Hunter 15 & U  
 611 3'3" Jr Hunter 15 & U U/S  
 617-618+ 3'3" Jr Hunter 16-17  
 616 **Clover Stone 3'3" Jr Hunter**  
 16-17 U/S

### Wheless Ring - 8:00 am

- 741 **JOJU WT Hunter**  
 742-743 WT Poles  
 716 Opp WTC  
 717-718 Opp WTC X-Rails  
 719 Opp WTC  
 720-721 Opp WTC 18"  
 777 Short Stirrup Eq - Flat  
 778 Short Stirrup Eq - Fences  
 702-703 Short Stirrup Hunter  
 780 Medium Stirrup Eq - Flat  
 781 Medium Stirrup Eq - Fences  
 707-708 Medium Stirrup Hunter  
 765 Long Stirrup Eq - Flat  
 766 Long Stirrup Eq - Fences  
 712-713 Long Stirrup Hunter

### Sand Ring - 7:30 am

- 570 Large Green Pony Hunter Model  
 786 Marshall & Sterling/US Pony Medal (open card)  
 572C-573+ Large Green Pony Hunter  
 571 Large Green Pony Hunter U/S  
 560 Sm/Med Green Pony Model  
 562C-563+ Sm/Med Green Pony Hunter  
 561 Sm/Med Green Pony Hunter U/S  
 530 Small Pony Hunter Model  
 760 Pony Equitation Fences  
 532C-533+ Small Pony Hunter  
 531 Small Pony Hunter U/S  
 540 Medium Pony Hunter Model  
 542C-543+ Medium Pony Hunter  
 541 Medium Pony Hunter U/S  
 550 Large Pony Hunter Model  
 552C-553+ Large Pony Hunter  
 551 Large Pony Hunter U/S  
 759 Pony Equitation - Flat  
 774 **The Pop Up Pony**  
 Children's Pony Equitation - Flat  
 775 **The Pop Up Pony**  
 Children's Pony Eq - Fences  
 622-623+ **The Pop Up Pony**  
 Children's Hunter Pony  
 621 **The Pop Up Pony**  
 Children's Hunter Pony U/S  
**Mega Ring II - 8:00 am**  
 771 Jr Equitation 14 & U - Flat  
 772-773 Jr Equitation 14 & U - Fences  
 794 THIS National Children's Medal  
 752 Children's Equitation 14/U - Fences  
 517-518+ Children's Hunter 14 & U  
 755 Children's Equitation 15-17 Fences  
 522-523+ Children's Hunter 15-17

## SUNDAY MARCH 30

### Main Indoor Ring - 8:00 am

- 350 1.25m NAL Jr/Am Classic II 2b(\$5000)  
 353 **Lynn & Pete Walsh**  
 1.30/1.40m NAL Jr/Am Clsc II 2b(\$10,000)  
 374 **Moore Insights & Strategy 1.15m NAL/**  
**WIHS Amat Classic II 2b(\$2000)**  
 377 **Kristie Scholten 1.15m**  
**NAL/WIHS Jr Classic II 2b(\$2000)**  
 796 WEC Premier Cup  
 793 Platinum Performance/USEF  
 Talent Search

### Tellepsen Arena - 8:00 am

- 252 0.60m Jumper II 2d  
 327 0.75m Training Jumper II 2b  
 380 0.90m Mod. Jr/Am Jumper II 2b  
 371 1.05m Junior Jumper Stake II 2b(\$1500)  
 368 1.05m Amateur Jumper Stake II 2b(\$1500)

### ESI Ring - 8:00 am

- 783 Low Children's Equitation - Flat  
 596 Low Children's Hunter U/S  
 784 Low Children's Equitation - Fences  
 599-600 Low Children's Hunter  
 683 \$500 Low Children's Hunter Classic  
 2nd Round

\* TX Hunter Stake and/or USHJA Incentive  
 + First Round of Classic  
 H Handy  
 C Conformation

### Mega Ring I - 8:00 am

- 768 Jr. Equitation 15-17 - Flat  
 769-770 Jr. Equitation 15-17 - Fences  
 788 ASPCA Maclay  
 499-500H 3'6" Lg Jr Hunter 16-17  
 494-495H 3'6" Lg Jr Hunter 15 & U  
 489-490H 3'6" Sm Jr Hunter 16-17  
 484-485H 3'6" Sm Jr Hunter 15 & U  
 685 **South Haven Farm \$1000**  
**3'6" Junior Hunter Classic - 2nd Round**  
 785 USHJA 3'3" Hunter Seat Medal  
 619-620H 3'3" Jr Hunter 16-17  
 614-615H 3'3" Jr Hunter 15 & U  
 686 **Pine Hollow Farm & TeriAnn Miller**  
**\$1000 3'3" Junior Hunter Classic- 2nd Round**

### Sand Ring - 8:00 am

- 787 WIHS Pony Equitation (Open Card)  
 574-575 Large Green Pony Hunter  
 564-565 Sm/Med Green Pony Hunter  
 678 \$1000 Green Pony Hunter Classic 2nd Round  
 534-535H Small Pony Hunter  
 544-545H Medium Pony Hunter  
 554-555H Large Pony Hunter  
 680 **Corient \$1500 Pony Hunter Classic**  
 - 2nd Round  
 624-625 **The Pop Up Pony**  
 Children's Pony Hunter  
 677 **BNY Wealth Management**  
**\$500 Children's Pony Hunter Classic**  
 - 2nd Round

### Mega Ring II - 8:00 am

- 754 Children's Equitation 15-17 - Fences  
 524-525 Children's Hunter 15-17  
 521 Children's Hunter 15-17 U/S  
 753 Children's Equitation 15-17 - Flat  
 676 **The Galvin Agency \$1000 NAL/WIHS**  
**Children's Hunter Classic 15-17**  
 - 2nd Round  
 751 Children's Equitation 14 & U - Fences  
 519-520 Children's Hunter 14 & U  
 516 Children's Hunter 14 & U U/S  
 750 Children's Eq 14 & Under - Flat  
 675 \$1000 NAL/WIHS Children's Hunter  
 Classic 14 & U 2nd Round

### Wheless Ring - 8:00 am

- 746 WT Horsemanship  
 747-748 WT Horsemanship Poles  
 726 Opp WTC  
 727-728 Opp WTC X-Rails  
 729 Opp WTC Eq.  
 730-731 Opp WTC 18"  
 704-705 Short Stirrup Hunter  
 701 Short Stirrup Hunter U/S  
 709-710 Medium Stirrup Hunter  
 706 Medium Stirrup Hunter U/S  
 714-715 Long Stirrup Hunter  
 711 Long Stirrup Hunter U/S



# SUSMAN GODFREY

SUPPORTS ITS EQUESTRIANS



AMBERLEA TRIBBLE  
DAUGHTER OF  
MAX TRIBBLE, PARTNER  
[MTRIBBLE@SUSMANGODFREY.COM](mailto:MTRIBBLE@SUSMANGODFREY.COM)



LAUREN HARRISON  
WIFE OF  
GEOFFREY HARRISON, PARTNER  
[GHARRISON@SUSMANGODFREY.COM](mailto:GHARRISON@SUSMANGODFREY.COM)

A PROUD SPONSOR OF

*The  
Pin Oak  
Charity Horse Show*

HOUSTON

LOS ANGELES

NEW YORK

SEATTLE



# Unparalleled capability.



Walsh & Albert has provided HVAC ductwork for some of the most visible landmark buildings constructed or remodeled in Houston over the last thirty-five years.

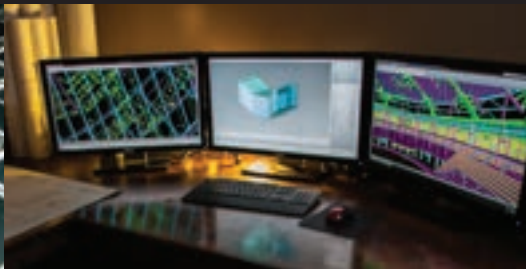

At Walsh & Albert, we strive for excellence in everything we do. Our reputation for performance, safety and value engineering on projects both difficult and routine is unparalleled in south Texas.

Also unparalleled is the incomparable Pin Oak Charity Horse Show.  
**Congratulations on the 79th year from the Walsh family.**



19300 Oil Center Boulevard, Houston, TX 77073  
281.449.2787 FAX: 281.449.2940  
866.520.7510 (Toll Free)  
[www.walshalbert.com](http://www.walshalbert.com)



## WEDNESDAY - APRIL 2

## Main Indoor Ring - 7:30 am

- 325 1.10 Jumper II  
357 1.10m 5 YO Jumper II  
329 1.15m Jumper II 2d (\$250)  
333 1.20m Jumper II 2d (\$500)  
360 1.20m 6 YO Jumper II 2d (\$500)  
363 1.30m 7 YO Jumper II 2d (\$500)  
336 1.30m Jumper II 2d (\$750)  
387 1.35m Jumper II 2d (\$1000)  
**393 Summer Hill Farm 1.40m**  
**Welcome Stake II 2b(\$10,000)**  
**395 1.40m U25 Welcome Stake(\$5000)**  
(concurrent w/393)  
**Tellepsen Arena - 8:00 am**  
301 0.75m Jumper II, 2d  
304 0.85m Jumper II, 2d  
307 0.90m Jumper II, 2d  
311 0.95m Jumper II, 2d  
314 1.0m Jumper II, 2d  
384 **Sam Houston Race Park**  
1.0m Take 2TB Jumper II 2d(\$100)  
318 1.05m Jumper II 2d  
322 1.10m Jumper II 2d(\$250)

## Mega Ring I - 7:30 am

- 400 Green Conformation Model  
410 HP Conformation Model  
427-428 High Performance Hunter  
426 High Performance Hunter U/S  
412-413 HP Conformation Hunter  
411 HP Conformation Hunter U/S  
422-423\* 3'9" Green Hunter  
1420 USHJA Green Incentive 3'6"/3'9"  
(concurrent w/423 & 418)  
421 3'9" Green Hunter U/S  
417-418\* 3'6" Green Hunter  
416 3'6" Green Hunter U/S  
402-403\* Green Conformation Hunter  
401 Green Conformation U/S  
432-433\* 3'6" Performance Hunter  
431 3'6" Performance Hunter U/S  
437-438\* 3'3" Performance Hunter  
436 3'3" Performance U/S  
**1435 GSS, The Marketing Agency**  
**TX 3'3"/3'6" Performance Stake**

## Mega Ring II - 8:00 am

- 457-458 **Lynn & Pete Walsh**  
3'3" Green Hunter  
456 **Lynn & Pete Walsh**  
3'3" Green Hunter U/S  
812-813 3'3" Young Hunter (7 & U)  
811 3'3" Young Hunter U/S (7 & U)  
452-453 3' Green Hunter  
451 3' Green Hunter U/S  
**ESI Ring - 8:00 am**  
407-408 2'6" Pin Oak Hunter  
582-583 Baby Green Hunter  
406 2'6" Pin Oak Hunter U/S  
672-673 3' Take 2 TB Hunter  
671 **Voltaire Design**  
Take 2 TB Hunter U/S

## Sand Ring

Ticketed Warm Up 8am- 12 noon  
not before 12:30 pm

- 656 Yearling HB  
657 Two Year Old HB  
658 Three Year Old HB  
659 Best Young Horse  
**1:30 pm**  
807-808 3' Young Hunter (6 & U)  
806 3' Young Hunter U/S (6 & U)  
802-803 2'9" Young Hunter (5 & U)  
801 2'9" Young Hunter U/S (5 & U)

Grand Prix Check In: 3-4 pm  
Main Indoor Arena Warm-Up RingWheless Arena - Ticketed Warm Up  
9:00 am - 5:00 pm

## THURSDAY - APRIL 3

## Main Indoor Ring - 8:00 am

- 326 1.10m Jumper II 1  
358 1.15m 5 YO Jumper II  
330 1.15m Jumper II 1(\$250)  
334 1.20m Jumper II 1(\$500)  
361 **International Welding Bureau**  
1.20m 6 YO Jumper II 1(\$500)  
364 1.30m 7 YO Jumper II 1(\$500)  
337 1.30m Jumper II 1(\$750)  
388 1.35m Jumper II 1(\$1000)  
**Not Before 4:00 pm**  
**396 Frio Vodka \$25,000 Pin Oak**  
**Charity Grand Prix**  
- American Standard II 2a  
**399 U25 Grand Prix II 2a(\$10,000)**  
(concurrent w/396)

## Mega Ring I - 8:00 am

- 429-430H High Performance Hunter  
414-415H HP Conformation Hunter  
424-425H 3'9" Green Hunter  
419-420H 3'6" Green Hunter  
404-405H Green Conformation Hunter  
434-435H 3'6" Performance Hunter  
462-463+ 3'6" AO Hunter 18-35  
467-468+ 3'6" AO Hunter 36 & Over

## Sand Ring - 8:00 am

- 757 Adult Eq - Fences (open card)  
502-503+ AA Hunter 50 & Over  
501 AA Hunter 50 & Over U/S  
507-508+ AA Hunter 36-49  
506 AA Hunter 36-49 U/S  
512-513+ AA Hunter 18-35  
511 AA Hunter 18-35 U/S  
756 Adult Eq - Flat  
627-628 2'9" Pin Oak Hunter  
626 2'9" Pin Oak Hunter U/S

## Mega Ring II - 8:00 am

- 454-455\* 3' Green Hunter  
1455 Texas Green Hunter Stake  
3' & 3'3"  
2455 USHJA Green Hunter Incentive  
(concurrent w/455 & 460)  
459-460\* **Lynn & Pete Walsh**  
3'3" Green Hunter  
439-440H 3'3" Performance Hunter  
472-473+ 3'3" AO Hunter 18-35  
477-478+ 3'3" AO Hunter 36 & Over

## ESI Ring - 8:00 am

- 581 Baby Green Hunter U/S  
587-588 2'6" Hopeful Hunter  
584-585 2'6" Baby Green Hunter  
592-593+ Low Adult Hunter

\* TX Hunter Stake and  
/or USHJA Incentive  
+ First Round of Classic  
H Handy  
C Conformation

## Tellepsen Arena - 8:00 am

- 302 0.75m Jumper II, 2b  
305 0.85m Jumper II, 2b  
308 0.90m Jumper II, 2b  
312 0.95m Jumper II, 2b  
315 1.0m Jumper II, 2b  
385 **Planet Fitness**  
1.0m Take 2 TB Jumper II 2b(\$100)  
319 1.05m Jumper II 2b  
323 1.10m Jumper II 2b(\$250)

Wheless Arena - Ticketed Warm Up  
9:00 am - 5:00 pm

## FRIDAY - APRIL 4

## Main Indoor Ring - 8:00 am

- 324 **The Maestas Family**  
1.10m Jumper II 2b(\$1000)  
331 1.15m Jumper II 1 (\$1000)  
359 1.15m 5 YO Jumper II  
335 **Brittany Tribble**  
1.20m Jumper II 2b(\$5000)  
362 1.20m 6 YO Jumper II 2b(\$500)  
365 1.30m 7 YO Jumper II 2b(\$500)  
392 1.30m Jumper Stake II 1(\$5000)  
389 1.40m Jumper II 2b(\$1000)  
351 1.30/1.40m Jr/Am Jump II 2d(\$1000)  
348 1.20m Jr/Am Jumper II 2d(\$750)  
COURSE CHANGE  
**7:30 pm**  
**690 Leaving One Out, LLC**  
**\$25,000 Open Hunter Classic**  
**3'6", 3'9", 4'**

## Mega Ring I - 8:00 am

- 471 3'3" AO Hunter 18-35 U/S  
474-475H 3'3" AO Hunter 18-35  
476 3'3" AO Hunter 36 & Over U/S  
479-480H 3'3" AO Hunter 36 & Over  
**688 Black Mare Bootery**  
**3'3" \$1000 AO Hunter Classic**  
- 2nd Round  
461 3'6" AO Hunter 18-35 U/S  
464-465H 3'6" AO Hunter 18-35  
466 3'6" AO Hunter 36 & Over U/S  
469-470H 3'6" AO Hunter 36 & Over

**687 Memorial Park Hunters**  
**3'6" \$1000 AO Hunter Classic**  
- 2nd Round

## Wheless Ring - 8:00 am

- 855-856 2'3" Pin Oak Hunter  
854 2'3" Pin Oak Hunter U/S  
852-853 2' Pin Oak Hunter  
858-859 2' S/M/L Stirrup Hnt Warm Up  
851 2' Pin Oak Hunter U/S  
857 2' S/M/L Stirrup Hnt Warm Up U/S

## Mega Ring II - 8:00 am

- 758 Adult Eq - Fences (Open Card)  
797 Ariat National Adult Medal  
800 THIS NHS Adult Amateur Medal  
504-505 **The Smith Sisters**  
AA Hunter 50 & Over  
509-510 AA Hunter 36-49  
514-515 AA Hunter 18-35  
**679 Stonewall Farm \$1000**  
**NAL/WIHS AA Hunter Classic**  
- 2nd Round  
528-529 3' Pin Oak Hunter  
527 3' Pin Oak Hunter U/S

## Sand Ring - 9:00 am

**681 Epic Sport Horses \$10,000**  
**USHJA National Hunter Derby**

## ESI Ring - 8:00 am

- 589-590 2'6" Hopeful Hunter  
586 2'6" Hopeful Hunter U/S  
591 Low Adult Hunter U/S  
762 Low Adult Eq. - Flat  
763 Low Adult Eq. - Fences  
594-595 Low Adult Hunter  
684 \$500 Low Adult Hunter Classic  
2nd Round

## Tellepsen Arena - 8:00 am

- 303 0.75m Jumper II, 2d  
306 0.85m Jumper II, 2d  
378 0.90m Mod. Jr/Am Jump II 2d  
316 1.0m Jumper II, 2d  
386 1.0m Take 2 TB Jumper II 2d(\$100)  
366 1.0m Amateur Jumper II 2d(\$250)  
372 1.10m Amateur Jumper II 2d(\$500)  
375 1.10m Junior Jumper II 2d(\$500)

Grand Prix Check In: 3-4 pm  
Main Indoor Arena Warm-Up RingS/M/L Stirrup Hunter Warm Up cards  
will be open with the  
2' Pin Oak Hunter



## SATURDAY - APRIL 5

### Main Indoor Ring - 8:00 am

- 349 1.20m Jr/Am Jumper II 1(\$750)  
 352 **Monarch Stables**  
 1.30/1.40m Jr/Am Jumper II 1(\$1000)  
 373 1.10m Amateur Jumper II 1(\$500)  
 376 1.10m Junior Jumper II 1(\$500)  
 795 USHJA 3'3" Adult Jumping Seat Medal  
 792 EMO USHJA 3'3" Jumping Seat Medal  
 791 WIHS Equitation Jumper Phase  
**7:00 pm - Opening Ceremonies**  
 30 **Johnson Equine Leadline** (no stallions)  
**7:30 pm**  
 398 **Southern Way Farm**  
**\$50,000 Pin Oak Charity Grand Prix**  
 - National Standard

### Tellepsen Arena - 8:00 am

- 250 0.60m Jumper IV 1  
 251 0.60m Jumper II 2d  
 321 0.75m Jumper IV 1  
 309 0.90m Jumper II 1  
 379 0.90m Mod. Jr/Am Jumper II 2b  
 317 1.0m Jumper II 1  
 369 1.0m Junior Jumper II 2d(\$250)  
 367 1.0m Amateur Jumper II 1(\$250)  
 370 1.0m Junior Jumper II 1(\$250)

### ESI Ring - 8:00 am

- 597-598+ Low Children's Hunter  
 799 THJA Mini Medal

### Mega Ring I - 8:00 am

- 790 WIHS Equitation - Hunter Phase  
 482-483+ 3'6" Sm Jr Hunter 15 & U  
 481 3'6" Sm Jr Hunter 15 & U U/S  
 487-488+ 3'6" Sm Jr Hunter 16-17  
 486 3'6" Sm Jr Hunter 16-17 U/S  
 492-493+ 3'6" Lg Jr Hunter 15 & U  
 491 3'6" Lg Jr Hunter 15 & U U/S  
 497-498+ 3'6" Lg Jr Hunter 16-17  
 496 3'6" Lg Jr Hunter 16-17 U/S  
 789 **On the Mark Equestrian**  
 Dover/USEF Hunt Seat Medal  
 798 Hamel NHS 3'3" Equitation  
 612-613+ 3'3" Jr Hunter 15 & U  
 611 3'3" Jr Hunter 15 & U U/S  
 617-618+ 3'3" Jr Hunter 16-17  
 616 **Clover Stone** 3'3" Jr Hunter  
 16-17 U/S

### Wheless Ring - 8:00 am

- 741 WT Hunter  
 742-743 WT Pole  
 716 Opp WTC  
 717-718 Opp WTC X-Rails  
 719 Opp WTC  
 720-721 Opp WTC 18"  
 777 Short Stirrup Eq - Flat  
 778 Short Stirrup Eq - Fences  
 702-703 Short Stirrup Hunter  
 780 Medium Stirrup Eq - Flat  
 781 Medium Stirrup Eq - Fences  
 707-708 Medium Stirrup Hunter  
 765 Long Stirrup Eq - Flat  
 766 Long Stirrup Eq - Fences  
 712-713 Long Stirrup Hunter

### Mega Ring II - 8:00 am

- 771 Jr Equitation 14 & U - Flat  
 772-773 Jr Equitation 14 & U - Fences  
 794 THIS National Children's Medal  
 752 Children's Equitation 14/U - Fences  
 517-518+ Children's Hunter 14 & U  
 755 Children's Equitation 15-17 - Fences  
 522-523+ Children's Hunter 15-17

### Sand Ring - 8:00 am

- 570 Large Green Pony Hunter Model  
 786 Marshall & Sterling/US Pony Medal  
 572C-573+ Large Green Pony Hunter  
 571 Large Green Pony Hunter U/S  
 560 Sm/Med Green Pony Hunter Model  
 562C-563+ Sm/Med Green Pony Hunter  
 561 Sm/Med Green Pony Hunter U/S  
 530 Small Pony Hunter Model  
 760 Pony Equitation Fences  
 532C-533+ Small Pony Hunter  
 531 Small Pony Hunter U/S  
 540 Medium Pony Hunter Model  
 542C-543+ Medium Pony Hunter  
 541 Medium Pony Hunter U/S  
 550 Large Pony Hunter Model  
 552C-553+ Large Pony Hunter  
 551 Large Pony Hunter U/S  
 759 Pony Equitation Flat  
 774 **The Pop Up Pony**  
 Children's Pony Eq - Flat  
 775 **The Pop Up Pony**  
 Children's Pony Eq - Fences  
 622-623+ **The Pop Up Pony**  
 Children's Hunter Pony  
 621 **The Pop Up Pony**  
 Children's Hunter Pony U/S

## SUNDAY - APRIL 6

### Main Indoor Ring - 7:30 am

- 353 **Rendezvous Farm 1.30/1.40m**  
**NAL Jr/Am Classic II 2b(\$10,000)**  
 350 **Brookside Pines 1.25m NAL**  
**Jr/Am Classic II 2b(\$5000)**  
 374 1.15m NAL/WIHS Amat Classic II 2b(\$2000)  
 377 1.15m NAL/WIHS Jr Classic II 2b(\$2000)  
 796 **Deloitte WEC Premier Cup**  
 793 Platinum Performance/USEF  
 Talent Search

### Tellepsen Arena - 8:00 am

- 252 0.60m Jumper II 2d  
 327 0.75m Jumper II 2b  
 380 0.90m Mod. Jr/Am Jumper II 2d  
 371 **October Hill Farm**  
**1.05m Junior Jumper Stake II 2b(\$1500)**  
 368 1.05m Amateur Jumper Stake II 2b(\$1500)

### ESI Ring - 8:00 am

- 783 Low Children's Eq - Flat  
 596 Low Children's Hunter U/S  
 784 Low Children's Eq - Fences  
 599-600 Low Children's Hunter  
 683 \$500 Low Children's Hunter Classic  
 2nd Round

\* TX Hunter Stake and/or USHJA Incentive  
 + First Round of Classic  
 H Handy  
 C Conformation

### Mega Ring I - 8:00 am

- 768 Jr Eq 15-17 - Flat  
 769-770 Jr Eq 15-17 - Fences  
 788 ASPCA Horsemanship  
 499-500H 3'6" Lg Jr Hunter 16-17  
 494-495H 3'6" Lg Jr Hunter 15 & U  
 489-490H 3'6" Sm Jr Hunter 16-17  
 484-485H 3'6" Sm Jr Hunter 15 & U  
 685 **The Smith Sisters**  
**\$1000 3'6" Junior Hunter Classic**  
 - 2nd Round  
 785 USHJA 3'3" Hunt Seat Medal  
 619-620H 3'3" Jr Hunter 16-17  
 614-615H 3'3" Jr Hunter 15 & U  
 686 **Pine Hollow Farm & TeriAnn Miller**  
**\$1000 3'3" Junior Hunter Classic**  
 - 2nd Round

### Mega Ring II - 8:00 am

- 754 Children's Equitation 15-17 - Fences  
 524-525 Children's Hunter 15-17  
 521 Children's Hunter 15-17 U/S  
 753 Children's Equitation 15-17 - Flat  
 676 **The Galvin Agency \$1000**  
**NAL/WIHS Children's Hunter Classic 15-17**  
 - 2nd Round  
 751 Children's Equitation 14 & U - Fences  
 519-520 Children's Hunter 14 & U  
 516 Children's Hunter 14 & U U/S  
 750 Children's Equitation 14 & U - Flat  
 675 \$1000 NAL/WIHS Children's Hunter  
 Classic 14 & U 2nd Round

### Sand Ring - 8:00 am

- 787 WIHS Pony Equitation (Open Card)  
 574-575 Large Green Pony Hunter  
 564-565 Sm/Med Green Pony Hunter  
 678 \$1000 Green Pony Hunter Classic 2nd Round  
 534-535H Small Pony Hunter  
 544-545H Medium Pony Hunter  
 554-555H Large Pony Hunter  
 680 **PIP Farm \$1500 Pony Hunter Classic**  
 - 2nd Round  
 624-625 **The Pop Up Pony** Children's Pony Hunter  
 677 **The Pop Up Pony \$500**  
**Children's Pony Hunter Classic**  
 - 2nd Round

### Wheless Ring - 8:00 am

- 746 WT Horsemanship  
 747-748 WT Horsemanship Poles  
 726 Opp WTC  
 727-728 Opp WTC X-Rails  
 729 Opp WTC Eq.  
 730-731 Opp WTC 18"  
 704-705 Short Stirrup Hunter  
 701 Short Stirrup Hunter U/S  
 709-710 Medium Stirrup Hunter  
 706 Medium Stirrup Hunter U/S  
 714-715 Long Stirrup Hunter  
 711 Long Stirrup Hunter U/S



# Stonewall Farm

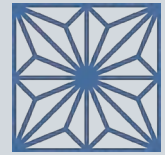

Hunters • Jumpers • Equitation

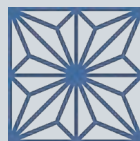

(214) 517-9886

[stonewallfarmllc.com](http://stonewallfarmllc.com)

3965 McCreary Rd, Allen, TX 75002





# ANDREW RYBACK PHOTOGRAPHY

OFFICIAL HORSE SHOW PHOTOGRAPHER

PHOTOGRAPHING ALL ROUNDS IN ALL RINGS

COME VISIT OUR TRAILER TO VIEW & PURCHASE YOUR SHOW PHOTOS

OR VISIT OUR WEBSITE (SCAN BELOW):

DIGITAL PHOTOS  
HIGH QUALITY PRINTS  
FULL-SHOW PACKAGES  
VIDEO REELS & CLIPS

224-318-5445



SCAN ME

UNIQUE GIFTS  
SPECIALTY ITEMS  
PORTRAIT SESSIONS  
BESPOKE OPTIONS

INFO@ANDREWRYBACK.COM





## WEDNESDAY - APRIL 9

**Main Indoor Ring - 7:30 am**

- 325 1.10 Jumper II  
357 1.10m 5 YO Jumper II  
329 1.15m Jumper II 2d (\$250)  
333 1.20m Jumper II 2d (\$500)  
360 1.20m 6 YO Jumper II 2d(\$500)  
363 1.30m 7 YO Jumper II 2d(\$500)  
336 1.30m Jumper II 2d (\$750)  
387 1.35m Jumper II 2d (\$1000)  
**393 Stonewell Farm**  
**1.40m Welcome Stake II 2b**  
**(\$15,000)**
- Tellepsen Arena - 8:00 am**  
301 0.75m Jumper II, 2d  
304 0.85m Jumper II, 2d  
307 0.90m Jumper II, 2d  
311 0.95m Jumper II, 2d  
314 1.0m Jumper II, 2d  
384 **Sam Houston Race Park**  
1.0m Take 2 TB Jumper II 2d(\$100)  
318 1.05m Jumper II 2d  
322 1.10m Jumper II 2d(\$250)

**Mega Ring I - 7:30 am**

- 400 Green Conformation Model  
410 HP Conformation Model  
427-428 High Performance Hunter  
426 High Performance Hunter U/S  
412-413 HP Conformation Hunter  
411 HP Conformation Hunter U/S  
422-423\* 3'9" Green Hunter  
1420 USHJA Green Incentive 3'6"/3'9"  
(concurrent w/423 & 418)  
421 3'9" Green Hunter U/S  
417-418\* 3'6" Green Hunter  
416 3'6" Green Hunter U/S  
402-403\* Green Conformation Hunter  
401 Green Conformation U/S  
432-433\* 3'6" Performance Hunter  
431 3'6" Performance Hunter U/S  
437-438\* 3'3" Performance Hunter  
436 3'3" Performance U/S  
**1435 GSS, The Marketing Agency**  
**TX 3'3"/3'6" Performance Stake**

**Mega Ring II - 8:00 am**

- 457-458 **Lynn & Pete Walsh**  
3'3" Green Hunter  
456 3'3" Green Hunter U/S  
812-813 3'3" Young Hunter (7 & U)  
811 3'3" Young Hunter U/S (7 & U)  
452-453 3' Green Hunter  
451 3' Green Hunter U/S  
**ESI Ring - 8:00 am**  
407-408 2'6" Pin Oak Hunter  
582-583 Baby Green Hunter  
406 2'6" Pin Oak Hunter U/S  
672-673 3' Take 2 TB Hunter  
671 **Curtis & Windham**  
Take 2 TB Hunter U/S

**Sand Ring**

- Ticketed Warm Up 8am- 12 noon**  
**not before 12:30 pm**  
656 Yearling HB  
657 Two Year Old HB  
658 Three Year Old HB  
659 Best Young Horse  
**1:30 pm**  
807-808 3' Young Hunter (6 & U)  
806 3' Young Hunter U/S (6 & U)  
802-803 2'9" Young Hunter (5 & U)  
801 2'9" Young Hunter U/S (5 & U)

**Wheless Arena - Ticketed Warm Up**  
**9:00 am - 5:00 pm**

**Grand Prix Check In: 3-4 pm**  
**Main Indoor Arena Warm-Up Ring**

## THURSDAY - APRIL 10

**Main Indoor Ring - 8:00 am**

- 326 1.10m Jumper II 1(\$250)  
358 1.15m 5 YO Jumper II  
330 1.15m Jumper II 1(\$250)  
334 1.20m Jumper II 1(\$500)  
361 **The Galvin Agency**  
1.20m 6 YO Jumper II 1(\$500)  
364 1.30m 7 YO Jumper II 1(\$500)  
337 1.30m Jumper II 1(\$750)  
388 1.35m Jumper II 1(\$1000)

**Not Before 4:00 pm**

- 396 Rudy's Bar-B-Q \$25,000**  
**Pin Oak Charity Grand Prix**  
**National Standard II 2a**

**Mega Ring I - 8:00 am**

- 429-430H High Performance Hunter  
414-415H HP Conformation Hunter  
424-425H 3'9" Green Hunter  
419-420H 3'6" Green Hunter  
404-405H Green Conformation Hunter  
434-435H 3'6" Performance Hunter  
462-463+ 3'6" AO Hunter 18-35  
467-468+ 3'6" AO Hunter 36 & Over  
**Sand Ring - 8:00 am**  
757 Adult Eq - Fences (open card)  
502-503+ AA Hunter 50 & Over  
501 AA Hunter 50 & Over U/S  
507-508+ AA Hunter 36-49  
506 AA Hunter 36-49 U/S  
512-513+ AA Hunter 18-35  
511 AA Hunter 18-35 U/S  
756 Adult Eq - Flat  
627-628 2'9" Pin Oak Hunter  
626 2'9" Pin Oak Hunter U/S

**Mega Ring II - 8:00 am**

- 454-455\* 3' Green Hunter  
1455 Texas Green Hunter Stake 3' & 3'3"  
2455 USHJA Green Hunter Incentive  
(concurrent w/455 & 460)  
459-460\* **Lynn & Pete Walsh**  
3'3" Green Hunter  
439-440H 3'3" Performance Hunter  
472-473+ 3'3" AO Hunter 18-35  
477-478+ 3'3" AO Hunter 36 & Over

**Tellepsen Arena - 8:00 am**

- 302 0.75m Jumper II, 2b  
305 0.85m Jumper II, 2b  
308 0.90m Jumper II, 2b  
312 0.95m Jumper II, 2b  
315 1.0m Jumper II, 2b  
385 1.0m Take 2 TB Jumper II 2b  
319 1.05m Jumper II 2b  
323 1.10m Jumper II 2b(\$250)

**ESI Ring - 8:00 am**

- 581 Baby Green Hunter U/S  
587-588 2'6" Hopeful Hunter  
584-585 2'6" Baby Green Hunter  
592-593+ Low Adult Hunter

**Wheless Arena - Ticketed Warm Up**  
**9:00 am - 5:00 pm**

**International Derby Check In : 2-3 pm**  
**Main Indoor Arena Warm-Up Ring**

## FRIDAY - APRIL 11

**Main Indoor Ring - 8:00 am**

- 331 1.15m Jumper II 1 (\$1000)  
359 1.15m 5 YO Jumper II  
335 1.20m Jumper II 2b(\$5000)  
362 1.20m 6 YO Jumper II 2b(\$500)  
365 1.30m 7 YO Jumper II 2b(\$500)  
**392 Brazos Valley Equine Hospitals**  
**1.30m Jumper Stake II 1(\$5000)**  
389 1.40m Jumper II 2b(\$1000)  
351 1.30/1.40m Jr/Am Jump II 2d(\$1000)  
348 1.20m Jr/Am Jumper II 2d(\$750)  
COURSE CHANGE

**7:30 pm**

- 682 Rio Agave \$30,000**  
**International Hunter Derby**

**Tellepsen Arena - 8:00 am**

- 303 0.75m Jumper II, 2d  
306 0.85m Jumper II, 2d  
378 0.90m Mod. Jr/Am Jumper II 2d  
316 1.0m Jumper II , 2d  
386 1.0m Take 2 TB Jumper II 2d(\$100)  
366 1.0m Amateur Jumper II 2d(\$250)  
372 1.10m Amateur Jumper II 2d(\$500)  
375 1.10m Junior Jumper II 2d(\$500)

**Mega Ring I - 8:00 am**

- 471 3'3" AO Hunter 18-35 U/S  
474-475H 3'3" AO Hunter 18-35  
476 3'3" AO Hunter 36 & Over U/S  
479-480H 3'3" AO Hunter 36 & Over  
**688 Blackk Mare Bootery**  
**3'3" \$1000 AO Hunter Classic**  
461 3'6" AO Hunter 18-35 U/S  
464-465H 3'6" AO Hunter 18-35  
466 3'6" AO Hunter 36 & Over U/S  
469-470H 3'6" AO Hunter 36 & Over  
**687 Pine Hollow Farm & TeriAnn Miller**  
**3'6" \$1000 AO Hunter Classic**  
- 2nd Round

**Wheless Ring - 8:00 am**

- 855-856 2'3" Pin Oak Hunter  
854 2'3" Pin Oak Hunter U/S  
852-853 2' Pin Oak Hunter  
858-859 2' S/M/L Stirrup Hnt Warm Up  
851 2' Pin Oak Hunter U/S  
857 2' S/M/L Stirrup Hnt Warm Up U/S

**Mega Ring II - 8:00 am**

- 758 Adult Eq - Fences (Open Card)  
797 Ariat National Adult Medal  
800 THIS NHS Adult Amateur Medal  
504-505 **The Smith Sisters**  
AA Hunter 50 & Over  
509-510 AA Hunter 36-49  
514-515 AA Hunter 18-35  
**679 Hedera Equestrian \$1000**  
**NAL/WIHS AA Hunter Classic**  
- 2nd Round  
528-529 3' Pin Oak Hunter  
527 3' Pin Oak Hunter U/S

**ESI Ring - 8:00 am**

- 589-590 2'6" Hopeful Hunter  
586 2'6" Hopeful Hunter U/S  
591 Low Adult Hunter U/S  
762 Low Adult Eq. - Flat  
763 Low Adult Eq. - Fences  
594-595 Low Adult Hunter  
684 \$500 Low Adult Hunter Classic  
2nd Round

**Sand Ring - 9:00 am**

- 681 Olde Oaks Farm \$15,000 USHJA**  
**National Hunter Derby**

**Grand Prix Check In: 3-4 pm**  
**Main Indoor Arena Warm-Up Ring**

\* TX Hunter Stake and/or USHJA Incentive  
+ First Round of Classic  
H Handy  
C Conformation

## SATURDAY - APRIL 12

### Main Indoor Ring - 8:00 am

- 349 **Elite Sport Horse** 1.20m  
Jr/Am Jumper II 1(\$750)  
352 **Rio Vista Farm** 1.30/1.40m Jr/Am  
Jumper II 1(\$1000)  
373 1.10m Amateur Jumper II 1(\$500)  
376 1.10m Junior Jumper II 1(\$500)  
795 USHJA 3'3" Adult Jumping Seat Medal  
792 EMO USHJA 3'3" Jumping Seat Medal  
791 WIHS Equitation Jumper Phase

### 7:00 pm - Opening Ceremonies

- 30 **Augusta Pines Leadline** (no stallions)  
7:30 pm  
398 **The Hildebrand Fund & River Oaks**  
**Donuts \$100,000 Pin Oak Charity**  
**Grand Prix - National Standard**

### Tellepsen Arena - 8:00 am

- 250 0.60m Jumper IV 1  
251 0.60m Jumper II 2d  
321 0.75m Jumper IV 1  
309 0.90m Jumper II 1  
379 0.90m Mod. Jr/Am Jumper II 2b  
317 1.0m Jumper II 1  
369 1.0m Junior Jumper II 2d(\$250)  
367 1.0m Amateur Jumper II 1(\$250)  
370 1.0m Junior Jumper II 1(\$250)

### ESI Ring - 8:00 am

- 597-598+ Low Children's Hunter  
799 THJA Mini Medal

### Mega Ring I - 8:00 am

- 790 WIHS Equitation - Hunter Phase  
482-483+ 3'6" Sm Jr Hunter 15 & U  
481 3'6" Sm Jr Hunter 15 & U U/S  
487-488+ 3'6" Sm Jr Hunter 16-17  
486 3'6" Sm Jr Hunter 16-17 U/S  
492-493+ 3'6" Lg Jr Hunter 15 & U  
491 3'6" Lg Jr Hunter 15 & U U/S  
497-498+ 3'6" Lg Jr Hunter 16-17  
496 3'6" Lg Jr Hunter 16-17 U/S  
789 Dover/USEF Hunt Seat Medal  
798 Hamel NHS 3'3" Equitation  
612-613+ 3'3" Jr Hunter 15 & U  
611 3'3" Jr Hunter 15 & U U/S  
617-618+ 3'3" Jr Hunter 16-17  
616 **Clover Stone** 3'3" Jr Hunter  
16-17 U/S

### Wheless Ring - 8:00 am

- 741 WT Hunter  
742-743 WT Pole  
716 Opp WTC  
717-718 Opp WTC X-Rails  
719 Opp WTC  
720-721 Opp WTC 18"  
777 Short Stirrup Eq - Flat  
778 Short Stirrup Eq - Fences  
702-703 Short Stirrup Hunter  
780 Medium Stirrup Eq - Flat  
781 Medium Stirrup Eq - Fences  
707-708 Medium Stirrup Hunter  
765 Long Stirrup Eq - Flat  
766 Long Stirrup Eq - Fences  
712-713 Long Stirrup Hunter

### Mega Ring II - 8:00 am

- 771 Jr Equitation 14 & U - Flat  
772-773 Jr Equitation 14 & U - Fences  
794 THIS National Children's Medal  
752 Children's Equitation 14/U - Fences  
517-518+ Children's Hunter 14 & U  
755 Children's Equitation 15-17 - Fences  
522-523+ Children's Hunter 15-17

### Sand Ring - 8:00 am

- 570 Large Green Pony Hunter Model  
786 Marshall & Sterling/US Pony Medal  
572C-573+ Large Green Pony Hunter  
571 Large Green Pony Hunter U/S  
560 Sm/Med Green Pony Hunter Model  
562C-563+ Sm/Med Green Pony Hunter  
561 Sm/Med Green Pony Hunter U/S  
530 Small Pony Hunter Model  
760 Pony Equitation Fences  
532C-533+ Small Pony Hunter  
531 Small Pony Hunter U/S  
540 Medium Pony Hunter Model  
542C-543+ Medium Pony Hunter  
541 Medium Pony Hunter U/S  
550 Large Pony Hunter Model  
552C-553+ Large Pony Hunter  
551 Large Pony Hunter U/S  
759 Pony Equitation Flat  
774 **The Pop Up Pony**  
Children's Pony Eq - Flat  
775 **The Pop Up Pony**  
Children's Pony Eq - Fences  
622-623+ **The Pop Up Pony**  
Children's Hunter Pony  
621 **The Pop Up Pony**  
Children's Hunter Pony U/S

## SUNDAY - APRIL 13

### Main Indoor Ring - 7:30 am

- 353 **Brazos Equine Veterinary Hospitals**  
**1.30/1.40m NAL Jr/Am Classic**  
II 2b(\$15,000)  
350 **Johson Equine** 1.25m NAL Jr/AM Classic  
II 2b(\$10,000)  
382 **Joy Warren** 1.15m NAL/WIHS Jr/Am Classic  
II 2b(\$10,000)  
796 WEC Premier Cup  
793 Platinum Performance/USEF  
Talent Search

### Tellepsen Arena - 8:00 am

- 252 0.60m Jumper II 2d  
327 0.75m Jumper II 2b  
380 0.90m Mod. Jr/Am Jumper II 2d  
381 **Osprey Jets** 1.05m Jr/Am Classic  
II 2b(\$5000)

### ESI Ring - 8:00 am

- 783 Low Children's Eq - Flat  
596 Low Children's Hunter U/S  
784 Low Children's Eq - Fences  
599-600 Low Children's Hunter  
683 \$500 Low Children's Hunter Classic  
2nd Round

### Mega Ring I - 8:00 am

- 768 Jr Eq 15-17 - Flat  
769-770 Jr Eq 15-17 - Fences  
788 ASPCA Horsemanship  
499-500H 3'6" Lg Jr Hunter 16-17  
494-495H 3'6" Lg Jr Hunter 15 & U  
489-490H 3'6" Sm Jr Hunter 16-17  
484-485H 3'6" Sm Jr Hunter 15 & U  
685 **Memorial Park Hunters**  
**\$1000 3'6" Junior Hunter Classic**  
2nd Round  
785 USHJA 3'3" Hunt Seat Medal  
619-620H 3'3" Jr Hunter 16-17  
614-615H 3'3" Jr Hunter 15 & U  
686 **Pine Hollow Farm & TeriAnn Miller**  
**\$1000 3'3" Junior Hunter Classic**  
2nd Round

### Mega Ring II - 8:00 am

- 754 Children's Equitation 15-17 - Fences  
524-525 Children's Hunter 15-17  
521 Children's Hunter 15-17 U/S  
753 Children's Equitation 15-17 - Flat  
676 **The Galvin Agency \$1000**  
**NAL/WIHS Children's Hunter Classic**  
**15-17 - 2nd Round**  
751 Children's Equitation 14 & U - Fences  
519-520 Children's Hunter 14 & U  
516 Children's Hunter 14 & U U/S  
750 Children's Equitation 14 & U - Flat  
675 \$1000 NAL/WIHS Children's Hunter  
Classic 14 & U 2nd Round

### Sand Ring - 8:00 am

- 787 WIHS Pony Equitation (Open Card)  
574-575 Large Green Pony Hunter  
564-565 Sm/Med Green Pony Hunter  
678 **Clear Round Show Jumpers**  
**\$1000 Green Pony Hunter Classic**  
534-535H Small Pony Hunter  
544-545H Medium Pony Hunter  
554-555H Large Pony Hunter  
680 **The Holstead Family \$1500**  
**Pony Hunter Classic - 2nd Round**  
624-625 **The Pop Up Pony**  
Children's Pony Hunter  
677 **The Pop Up Pony \$500 Children's**  
**Pony Hunter Classic - 2nd Round**

### Wheless Ring - 8:00 am

- 746 WT Horsemanship  
747-748 WT Horsemanship Poles  
726 Opp WTC  
727-728 Opp WTC X-Rails  
729 Opp WTC Eq.  
730-731 Opp WTC 18"  
704-705 Short Stirrup Hunter  
701 Short Stirrup Hunter U/S  
709-710 Medium Stirrup Hunter  
706 Medium Stirrup Hunter U/S  
714-715 Long Stirrup Hunter  
711 Long Stirrup Hunter U/S

\* TX Hunter Stake and/or USHJA Incentive  
+ First Round of Classic  
H Handy  
C Conformation



# Save the Date 2025



Find  
Prize Lists & Schedules  
**GSWEC.COM**



Office Use Only

PIN OAK CHARITY I, II, III

March 26, 2025 To April 13, 2025



NAME OF HORSE	USEF	GREEN	BREED	COLOR	SEX	HEIGHT	AGE
Horse name							

Emergency Contact:	Remarks
--------------------	---------

CLASSES ENTERED	NAME OF RIDER	CTZ	DOB	AGE	USEF
1,2,3					
4,5,6					

US EQUESTRIAN FEDERATION ENTRY AGREEMENT

By entering a Federation-licensed Competition and signing this entry blank as the Owner, Lessee, Trainer, Manager, Agent, Coach, Driver, Rider, Handler, or other person, I agree to be bound by the Bylaws and Rules of the United States Equestrian Federation, Inc. (the "Federation") and the local rules of [Competition] (Competition). I agree to be bound by the Bylaws and Rules of the Federation and of the competition. I will accept as final the decision of the Hearing Committee on any question arising under the Rules, and agree to release and hold the Federation and of the Federation, their officials, directors and employees for any action taken under the Rules. I represent that I am eligible to enter and participate under the Rules, and every horse I am entering is eligible as entered. I also agree that as a condition of and in consideration of acceptance of entry, the Federation and/or the Competition will use or assign photographs, videos, audios, cable-casts, broadcasts, internet, film, new media or other likenesses of me and my horse during the course of the competition for the promotion, coverage or benefit of the competition, sport, or the Federation. Those likenesses shall not be used to advertise a product and may not be used in such a way as to jeopardize amateur status. I hereby expressly and irrevocably waive and release any and all claims, demands, damages, compensation, invasion of privacy, right of publicity, or to misappropriation. The construction and application of these terms and conditions shall be governed by the laws of the State of New York, and any action instituted against the Federation must be filed in New York State. See GR908.4.

If not currently a USEF Active Competing member or Subscriber, I acknowledge that I will be enrolled for membership in the Federation and my amount will continue to be annually automatically renew in USEF's sole discretion. Additionally, I acknowledge that the bylaws of a USEF are subject to change without notice. USEF may in its sole discretion, at any time, terminate my USEF Fan status. I may opt out of my USEF Fan status by going to My USEF Dashboard at (859) 810-8733.

**BY SIGNING BELOW, I AGREE** that I have read, understand, and agree to be bound by the applicable Federation Bylaws, rules and policies including the USEF Safe Sport Policy and Minor Athlete Abuse Prevention Policies (MAAPP) as published at [www.usef.org](http://www.usef.org) and all amendments and provisions of this Prize List. If I am signing and submitting this Agreement electronically, I acknowledge that my electronic signature shall have the same validity, force and effect as if I affixed my signature by my own hand.

QUANTITY	FEE DESCRIPTION	EACH	TOTAL
1	BREEDING HORSE STALL	\$100.00	
1	NIGHT WATCH PER HORSE	\$25.00	
1	USEF FEE	\$23.00	
1	OFFICE FEE	\$80.00	
1	USHJA FEE	\$10.00	
1	STALL	\$350.00	

OWNER		PRIZE PAYEE		RIDER 1		RIDER 2	
Name							
Street							
City							
State/Zip							
Telephone							
USEF							
SSN for payee *		*				*	
Signature *		*				*	

# Unparalleled capability.



Walsh & Albert has provided HVAC ductwork for some of the most visible landmark buildings constructed or remodeled in Houston over the last thirty-five years.

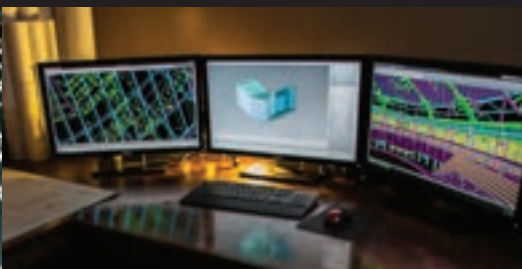

At Walsh & Albert, we strive for excellence in everything we do. Our reputation for performance, safety and value engineering on projects both difficult and routine is unparalleled in south Texas.

Also unparalleled is the incomparable Pin Oak Charity Horse Show.  
**Congratulations on the 77th year from the Walsh family.**



19300 Oil Center Boulevard, Houston, TX 77073  
281.449.2787 FAX: 281.449.2940  
866.520.7510 (Toll Free)  
[www.walshalbert.com](http://www.walshalbert.com)





# Hunton

2011 • 2012 • 2015 • 2016 • 2017 • 2018

**HOUSTON★CHRONICLE**  
TOP WORKPLACES

2019 • 2020 • 2021 • 2022 • 2023 • 2024



**FAMILY OWNED**  
BUSINESS AWARDS



WE EXIST TO RADICALLY IMPROVE THE INDOOR ENVIRONMENTS IN WHICH PEOPLE LIVE, WORK, LEARN, AND PLAY.

# SERVING HOUSTON SINCE 1981

[www.HuntonGroup.com](http://www.HuntonGroup.com)

  #HuntonProud #HuntonCares

SCAN HERE TO SEE  
CURRENT CAREER  
OPPORTUNITIES ➔





# FRIO

RIVER

VODKA



☀️ handcrafted from a  
blend of grain & wheat

☀️ cold filtered

☀️ sustainable

Partnered  
with



**AMERICAN  
RIVERS**  
Life Depends on Rivers™



**FIND FRIO  
VODKA**



# *The Pin Oak Charity Horse Show*



## SAVE THE DATE

---

79th PIN OAK CHARITY BREED HORSE SHOW  
MARCH 18 - MARCH 21, 2026

---

79th PIN OAK CHARITY H/J HORSE SHOW  
MARCH 24 - APRIL 11, 2026

---

GREAT SOUTHWEST EQUESTRIAN CENTER  
2501 S. MASON ROAD, SUITE 100  
KATY, TX 77450

TO BENEFIT



Texas Children's  
Hospital

PINOAK.ORG



#PINOAK2025